

MODEL # VICC



SPECIFICATIONS

The Vienna Series VICC is a combination of our Vienna Grab N' Go and Cold Display. The upper display area is full service with (1) shelf with lights. Refrigerated deck area with non-refrigerated mezzanine shelf. The lower area features a self-service section and includes (1) refrigerated shelf with lights. The rear houses an area for cold pans and includes a sliding utility board.

Designed to accommodate standard hotel / foodservice pans (to be purchased by others).

Available lengths: ☐ 47 1/4" ☐ 60" ☐ 72 7/8"

Available depths: ☐ 51 5/8"

Available heights: ☐ 53 7/8"

STANDARD FEATURES

- 304 Stainless Steel Exterior
- Tempered Tilt-Out Curved Glass with Side Glass Panels (Upper Section)
- Rear Sliding Access Doors (Upper Section)
- Rear Cold Pans (Operator Side)
- Rear Sliding Cutting Board
- Easy Removable Deck Pans for Cleaning
- Energy Efficient LED Lighting
- Programmable Digital Refrigeration Controller
- Forced Air Cooling System
- Lift-Up Evaporator
- Rear Cold Pan Substructure Detachable.
- Unit Shipped in two pieces with quick disconnects.
- ETL Listed in Accordance with UL 471 and NSF 7 Standards
- Environmentally Safe Refrigerant
- 5 Year Compressor Warranty
- Floor Drain Required

OPTIONAL FEATURES

- ☐ Remote Refrigeration
- ☐ Field installation required. Consult Factory for details.



Conforms to UL Standard 471, and NSF Standard 7; Certified To CSA Standard C22.2 No. 120

MODEL	L	D*	H	AIR SCREEN HP	COLD DISPLAY HP	VOLT	AMP	PLUG	WT	REFRIG.
VICC-48-R-CV-SC	47 1/4	51 5/8	53 7/8	3/4	3/8	115/208-230	13	L14-20P	704	134A/404A
VICC-60-R-CV-SC	60	51 5/8	53 7/8	7/8	1/2	115/208-230	17	L14-30P	880	134A/404A
VICC-72-R-CV-SC	72 7/8	51 5/8	53 7/8	1 1/4	1/2	115/208-230	21	L14-30P	1056	134A/404A

*Depth does not include slide-out cutting board. Add 15 3/8" in open position.

CALL TOLL FREE: 800-525-3692 (609-714-2330)

FAX: 609-714-2331 www.rpiindustries.com

220 ROUTE 70, MEDFORD, NJ 08055

RPI INDUSTRIES, INC. v8_23_17

MODEL # VICC

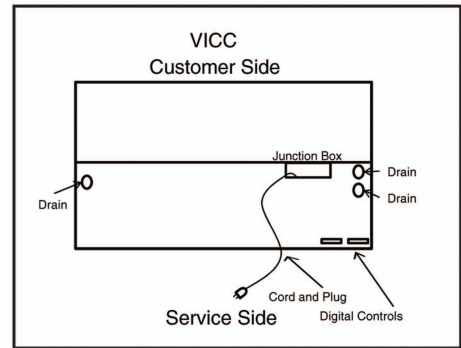
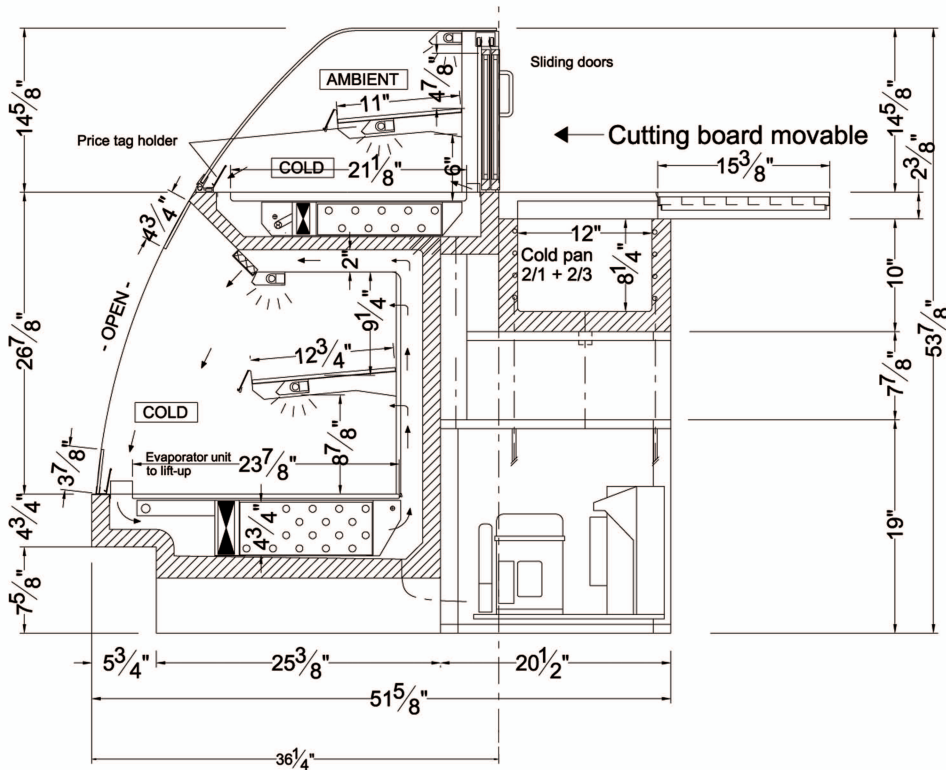

Electrical & Plumbing locations

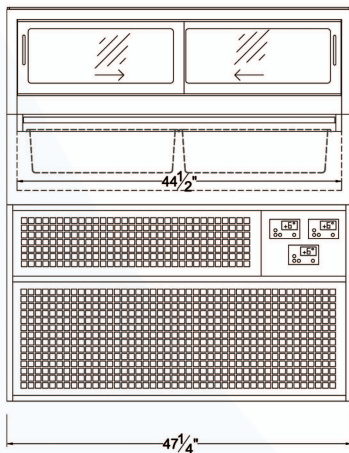

VICC-48-R-CV-SC

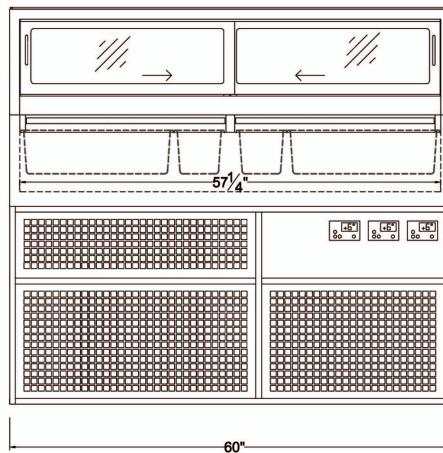

VICC-60-R-CV-SC

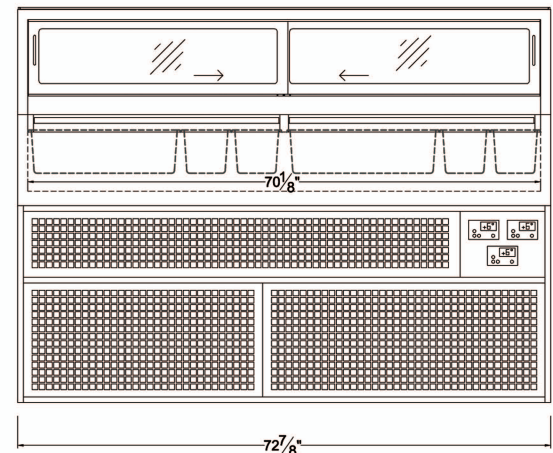

VICC-72-R-CV-SC

1. A 1" diameter drain is provided. The drain **MUST** be run to a floor drain **AT TIME OF INSTALLATION**.
2. RPI Merchandiser is designed for use in stores where ambient temperatures and humidity do not exceed 75 Degrees Fahrenheit and 55% R.H. Locate away from direct sunlight, rapid air currents and extreme temperature changes. Exposure to air currents from ceiling fans, air conditioning diffusers, ovens, etc. will disrupt the case air curtain and refrigerated zone. Refrigerated Displays are designed to maintain pre-chilled products. Adding or loading warm products above 41 Degrees Fahrenheit can affect the temperature in the entire cabinet. Any adverse field conditions stated above will void warranty.

RPI in line with its policy to continually improve its products reserves the right to change materials and specifications without notice.

CALL TOLL FREE: 800-525-3692 (609-714-2330)

FAX: 609-714-2331 www.rpiindustries.com

220 ROUTE 70, MEDFORD, NJ 08055