

REFCON SWINS

SHIPMENT IN 10 DAYS OR LESS!



Our most Popular Air Screen!

TOP SELLING FEATURES

- Includes Night Shade
- LED Lighting on Vertical Front Interior End
- Black interior
- Black shelving
- Black hemmed deck pan to contain spills
- Unique design allows front air intake / top rear air discharge within 32" - **no rear spacer required!**
- NSF Type II & DOE 2017 compliant!

MODEL

SWINS048

SWINS060

SWINS072

Laminate Options

949-58 White

9244-58 Classic White

459-58 Brite White

7197-58 Dover White

920-58 Almond

927-58 Folkstone

9242-58 Gull Grey

961-58 Fog

756-58 Natural Maple

86992-58 Hard Rock Maple

7012-58 Amber Maple

9237-58 Sand Maple

909-58 Black

9238-58 Chelsea Maple

5904-43 Wild Cherry

9240-58 Cherry Hardwood

9236-43 (V4) Noble Mahogany

9300-58 Grey Grafix

8955-43 Cinnamon Cherry

9288-43 (V4) Kona

Quantities limited and available on a first come, first serve basis
Contact RPI customer service for additional information

MODEL # SWINS48
SPECIFICATIONS

The SWIN Air Screen is a refrigerated Grab And Go style refrigeration. The self-contained refrigeration system includes digital controls allowing unit to engage in minimal defrost cycles. Front air intake, with rear air discharge reducing noise level with zero clearance from wall installation, unit comes standard with (4) adjustable shelves and vertically mounted LED lights and (1) LED canopy light.

Available lengths: ☐ 48" ☐ 60" ☐ 72"

Available depths: ☐ 32"

Available heights: ☐ 80"

STANDARD FEATURES

- DOE 2017 Compliant
- Self-Contained Refrigeration
- Squared Top Canopy
- Metal Frame Base Construction with Lift-Out Black Louvered Air Grill for Easy Access to Compressor
- Black Laminate Exterior
- (1) LED Canopy Light
- (2) Vertically Mounted LED Lights
- (4) Adjustable Black Shelves
- Black Hemmed Deck Pan to Contain Spills
- Energy Efficient #23 Pull-Down Night Curtain
- Black Perforated Interior Back Panel
- Electronic Digital Control and Defrost Termination
- Digital Temperature Display
- Front Air Intake with Top Rear Air Discharge for Zero Clearance From Wall
- Easy Slide-Out Condensing Unit (4', 5' & 6' Units)
- 8' Cord and Plug
- ETL Listed in Accordance with UL 471 and NSF 7 Standards
- Conforms to NSF STD 7 Type II Refrigeration
- Environmentally Safe Refrigerant
- Condensate Evaporator System
- Thermometer
- 1 Year Parts and Labor Warranty
- 5 Year Compressor Warranty

OPTIONAL FEATURES

- ☐ Casters (Increases Height by 6")
- ☐ Adjustable Legs (Increase Height By 6")
- ☐ LED Lights Under Shelves (in lieu of vertical lights)
- ☐ Roll Down Locking Cover
- ☐ Removable Security Panel
- ☐ Stainless Steel Exterior Finish
- ☐ Stainless Steel Shelves
- ☐ Exterior Laminate Finishes
 - ☐ 949-58 White
 - ☐ 9244-58 Classic White
 - ☐ 459-58 Brite White
 - ☐ 7197-58 Dover White
 - ☐ 920-58 Almond
 - ☐ 927-58 Folkstone
 - ☐ 9243-58 Zen Grey
 - ☐ 9242-58 Gull Grey
 - ☐ 961-58 Fog
 - ☐ 756-58 Natural Maple
 - ☐ 86992-58 Hard Rock Maple
 - ☐ 7012-58 Amber Maple
 - ☐ 9237-58 Sand Maple
 - ☐ 9238-58 Chelsea Maple
 - ☐ 5904-43 Wild Cherry
 - ☐ 9240-58 Cherry Hardwood
 - ☐ 9236-43 (V4) Noble Mahogany
 - ☐ 9300-58 Grey Grafix
 - ☐ 8955-43 Cinnamon Cherry
 - ☐ 9288-43 (V4) Kona
 - ☐ 9374-43 Cocoa Oak



REFCON™ Division of RPI Industries
 220 Route 70, Medford, NJ 08055



CALL TOLL FREE: 800-525-3692 (609-714-2330)

FAX: 609-714-2331 www.rpiindustries.com

220 ROUTE 70, MEDFORD, NJ 08055



RPI INDUSTRIES, INC. v10_4_19

MODEL # SWINS48

SELF - CONTAINED

MODEL	L	D	H	HP	VOLT	AMP	PLUG	WT
SWINS48	48	32	80	1	115/208-230 4 wire	11.7	L14-20P	900
SWINS60	60	32	80	1 1/4	115/208-230 4 wire	12.4	L14-20P	1020
SWINS72	72	32	80	1 1/4	115/208-230 4 wire	13.2	L14-20P	1150

NOTE: A minimum of 18" clearance needed above unit for air discharge for self contained units.

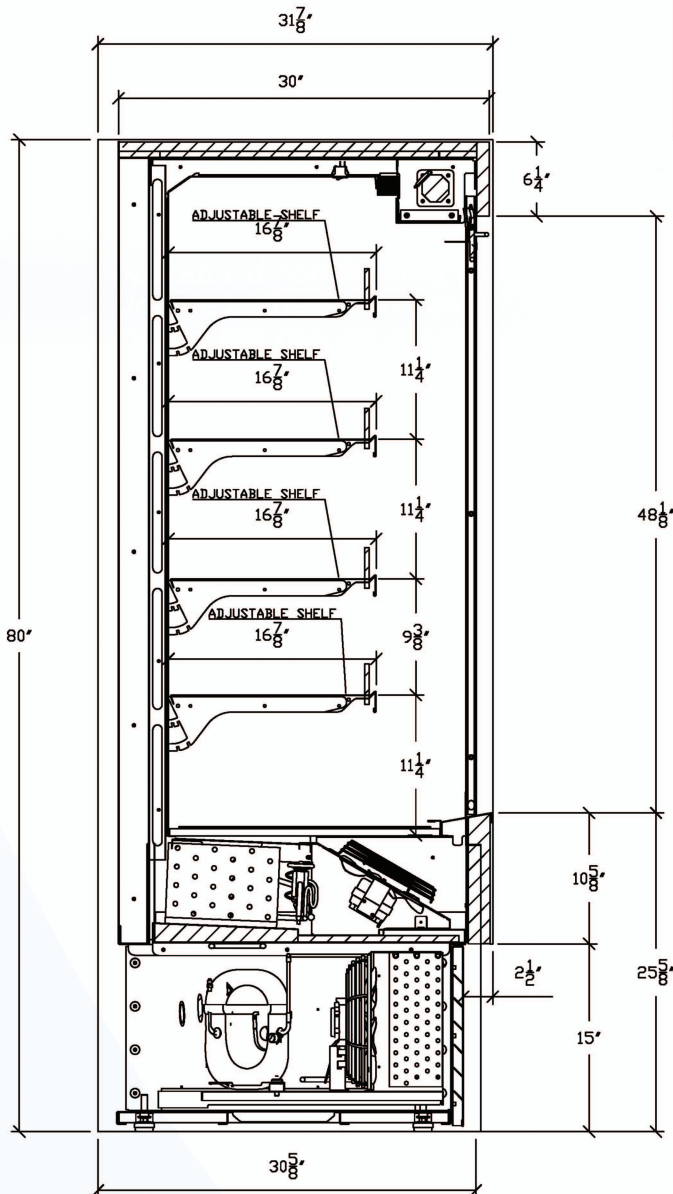

Electrical & Plumbing locations



Conforms to UL Standard 471,
and NSF Standard 7; Certified
To CSA Standard C22.2 No.120

Conforms to NSF STD 7
TYPE II

DOE 2017
Energy Efficiency
Compliant

RPI refrigerated merchandisers configured for sale for use in the United States meet or surpass the requirements of the DOE 2017 energy efficiency standards



REFCON™

1. All Self-Contained, Remote Units must be run to a floor drain at time of installation.
2. Refrigeration System is designed so air will flow front to rear. Unobstructed air flow must be maintained to ensure unit performance and maintain warranty.
3. The SWINS48 merchandiser is designed for use in stores where ambient temperatures and humidity do not exceed 80 Degrees Fahrenheit and 60% R.H. Locate away from direct sunlight, rapid air currents and extreme temperature changes. Exposure to air currents from ceiling fans, air conditioning diffusers, ovens, etc. will disrupt the case air curtain and refrigerated zone. Refrigerated Displays are designed to maintain pre-chilled products. Adding or loading warm products above 41 Degrees Fahrenheit can affect the temperature in the entire cabinet. Any adverse field conditions stated above will void warranty.

RPI in line with its policy to continually improve its products reserves the right to change materials and specifications without notice.

CALL TOLL FREE: 800-525-3692 (609-714-2330)

FAX: 609-714-2331 www.rpiindustries.com

220 ROUTE 70, MEDFORD, NJ 08055



RPI INDUSTRIES, INC. v10_4_19