

VIENNA-PRO



HEATED GRAB & GO

FEATURES

- #4 Stainless Exterior
- Gray Trim Insulated Glass / Square Profile
- Heated Black Glass Shelves With Infrared Top Mount
- Canopy Lights
- Hinged Rear Doors
- LED Lighting
- Slide In Base For Counter Install
- Optional Flex Panel Front And Side

MODEL

VIHD2-27-R-SQ-CO-INS PRO

VIHD3-27-R-SQ-CO-INS PRO

Quantities *limited* and available on a *first come, first serve* basis
Contact RPI customer service for additional information

VIENNA **PRO** HEATED DISPLAY SERIES

PROJECT: _____
ITEM: _____ **QUANTITY:** _____

MODEL # VIHD-SQ-CO-INS PRO (GRAB & GO)

SPECIFICATIONS

The Vienna PRO Series heated VIHD-SQ-CO-INS PRO is a freestanding self service, style merchandiser with a stainless steel exterior / interior and tube steel constructed base. Features include a square glass profile with insulated glass top and sides, 1 black glass shelf and Energy efficient LED lighting under the shelf and top canopy. The unit is available in two lengths, designed as free-standing, and with a base to accommodate optional flex series panel system. Units can also be used as a slide-in style display, with optional trim-flange and legs.

Available lengths: ☐ 31 1/8" ☐ 43 7/8"
Available depths: ☐ 27 3/8"
Available heights: ☐ 27 3/8" (Display Area)

UNITS CAN BE DESIGNED FOR CONTINUAL
MODULAR SHOWCASE LINE-UPS!



UNIT SHOWN WITH OPTIONAL FLEX SERIES PANELING

STANDARD FEATURES

- Squared glass profile
- **Top Display Area:** Grey Trim Glass with #4 stainless steel interior & exterior
- PRO Series base finished in #4 stainless steel
- Insulated glass sides & top panel
- Open front for self serve application
- Hinged rear see-through access doors
- (1) Black glass shelf with heated plate
- Black glass deck with heated plate
- Temperature adjustable between 149° - 185° F
- (2) Infrared heat lamps with top canopy light
- Energy efficient LED lighting
- Programmable digital display controller
- 6' Cord & Plug
- Adjustable Levelers
- ETL listed in accordance with UL 197 and NSF 4 standards

OPTIONAL FEATURES

- ☐ Powder Coat Exterior (20 Available colors, see color chart)
- ☐ #8 Mirror Polished Stainless Steel Exterior Trim
- ☐ Decorative Trim Ring (designed for drop-in style appearance to cover the seam in counter. This is a non-weight bearing ring - to be shipped loose)
- ☐ Flex Series Paneling Profiles:
 - ☐ HF (Half Full) ☐ HT (Half Tapered)
- ☐ Flex Series Flat Paneling Finish Options:
 - ☐ #4 Brushed Stainless Steel ☐ #8 Mirror Polished Stainless Steel
 - ☐ Laminate ☐ Wood Veneer
- ☐ 6" Casters *
- ☐ 6" Adjustable Legs *
- ☐ 8" Adjustable Legs *



Conforms to UL Standard 197,
and NSF Standard 4; Certified
To CSA Standard C22.2 No.109

(CO) OPEN GRAB & GO DISPLAY

MODEL	L	D	H	VOLTS	AMP	PLUG	WT	CUT-OUT SIZES**
VIHD2-27-R-SQ-CO-INS PRO	31 1/8	27 3/8	27 3/8	208-240	6.3	6-15P	372	31 1/2 x 27 5/8
VIHD3-27-R-SQ-CO-INS PRO	43 7/8	27 3/8	27 3/8	208-240	8.2	6-15P	416	44 3/8 x 27 5/8

* **NOTE / IMPORTANT:** ADD 6" ADJUSTABLE LEGS / 6" CASTERS for 34" COUNTER HEIGHT / ADD 8" ADJUSTABLE LEGS for 36" COUNTER HEIGHT

** **CUT-OUT SIZES FOR SLIDE-IN APPLICATION**



CALL TOLL FREE: 800-525-3692 (609-714-2330)

FAX: 609-714-2331 www.rpiindustries.com

220 ROUTE 70, MEDFORD, NJ 08055



RPI INDUSTRIES, INC. v9_17_19

VIENNA **PRO** HEATED DISPLAY SERIES

PROJECT: _____

TOLL FREE: 800-525-3692

MODEL # VIHD-SQ-CO-INS PRO (GRAB & GO)

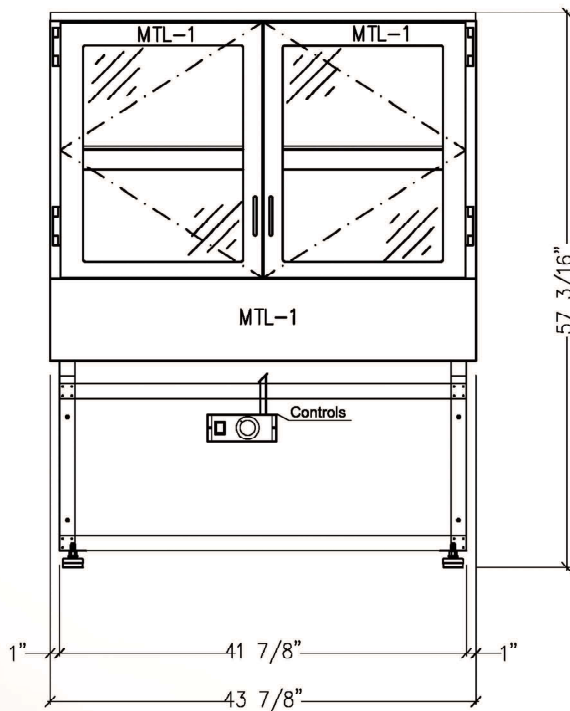

VIHD3-27-R-SQ-CO-INS PRO

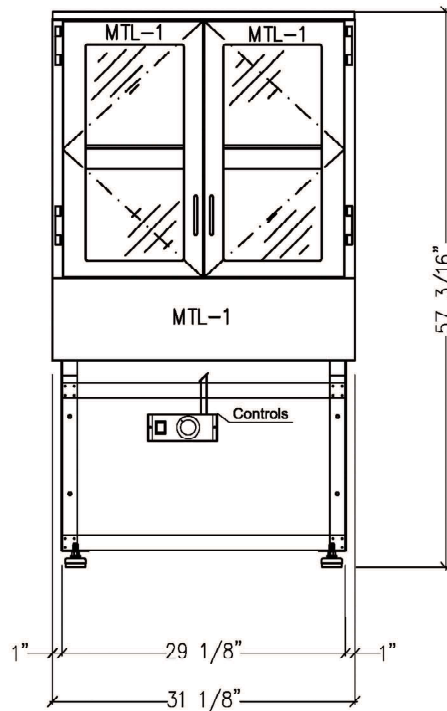

VIHD2-27-R-SQ-CO-INS PRO

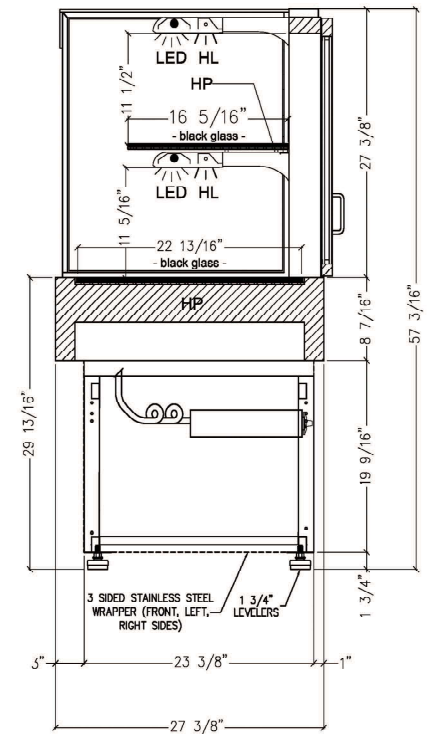

OPEN GRAB & GO (VIHD-CO)

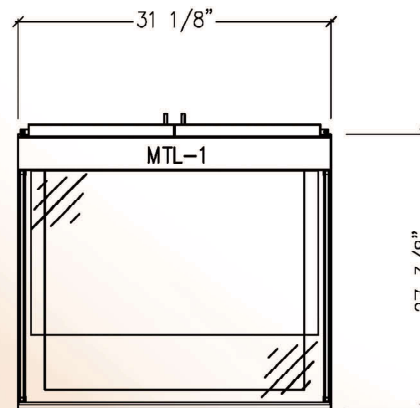

NOTE / IMPORTANT: VIENNA HEATED PRO SERIES DISPLAYS ARE PROVIDED WITH 6' CORD & PLUG ATTACHED TO THE CONTROL HOUSING

[CONSULT FACTORY FOR ADDITIONAL INFORMATION](#)

RPI in line with it's policy to continually improve it's product reserves the right to change materials and specifications without notice.

CALL TOLL FREE: 800-525-3692 (609-714-2330)

FAX: 609-714-2331 www.rpiindustries.com

220 ROUTE 70, MEDFORD, NJ 08055

RPI INDUSTRIES, INC. v9_17_19