

MODEL # VIAS1+VICD3-27-R-SQ-SC-INS-FLAN

SPECIFICATIONS

The Flantastic line is designed to maximize product freshness! Unit offers a uniquely designed coil with variable speed fans, which enables you to achieve very high natural humidity levels for preservation of product. This in-turn provides longer product shelf life!

- Available lengths: 71 7/8"
 Available depths: 40 3/4"
 Available heights: 55 3/4"



STANDARD FEATURES

- Squared Glass Profile
- 304 Stainless Steel Exterior
- Insulated Glass Top and Side Panels,
- Energy Efficient LED Lighting
- Rear See-Through Access Doors with mirrored stainless steel interior
- Rear Pull-out Product Access Drawer (VICD)
- Rear Pull-out Shelving Trays (VICD) & Deck Pans (VICD + VIAS) for Easy Access and Cleaning
- Programmable Digital Refrigeration Controller
- Self-Contained Refrigeration
- Rear Air Ventilation Kit
- Fan Assisted Cooling System
- Flantastic coil for increased air humidity
- ETL Listed in Accordance with UL 471 and NSF 7 Standards
- Environmentally Safe Refrigerant
- 5 Year Compressor Warranty
- Designed for Floor Drain

OPTIONAL FEATURES

- Remote Refrigeration
- Black Powder Coat Exterior Finish
- Removable Acrylic Locking Night Cover
- Integrations Modular Counter (Consult Factory)
- Flex Series Paneling Profiles:
 - FP (Full Front) HP (Half Front) Half Tapered
- Flex Series Flat Paneling Finish Options:
 - #4 Brushed Stainless Steel #8 Mirror Polished Stainless Steel
 - Laminate Wood Veneer
- Adjustable Legs & Casters (Slide-In Units)
 - 6" Legs 8" Legs
 - 6" Casters

* DEPTH INCLUDES REAR PULL-OUT PRODUCT ACCESS DRAWER

Self-Contained	L	D*	H	HP	VOLT	AMPS	PLUG	WT	REFRIG.
VIAS1+VICD3-27-R-SQ-SC-INS-FLAN	71 7/8	40 3/4	55 3/4	1/2	208-230V	16.6	L14-20P	1080	R448A

Remote	L	D*	H	BTU @ 14°F	VOLT	AMPS	PLUG	WT	REFRIG.
VIAS1+VICD3-27-R-SQ-RR-INS-FLAN	71 7/8	40 3/4	55 3/4	4539	115V	1.2	5-15P	1045	R448A

CALL TOLL FREE: 800-525-3692 (609-714-2330)
 FAX: 609-714-2331 www.rpiindustries.com
 220 ROUTE 70, MEDFORD, NJ 08055

MODEL # VIAS1+VICD3-27-R-SQ-SC-INS-FLAN

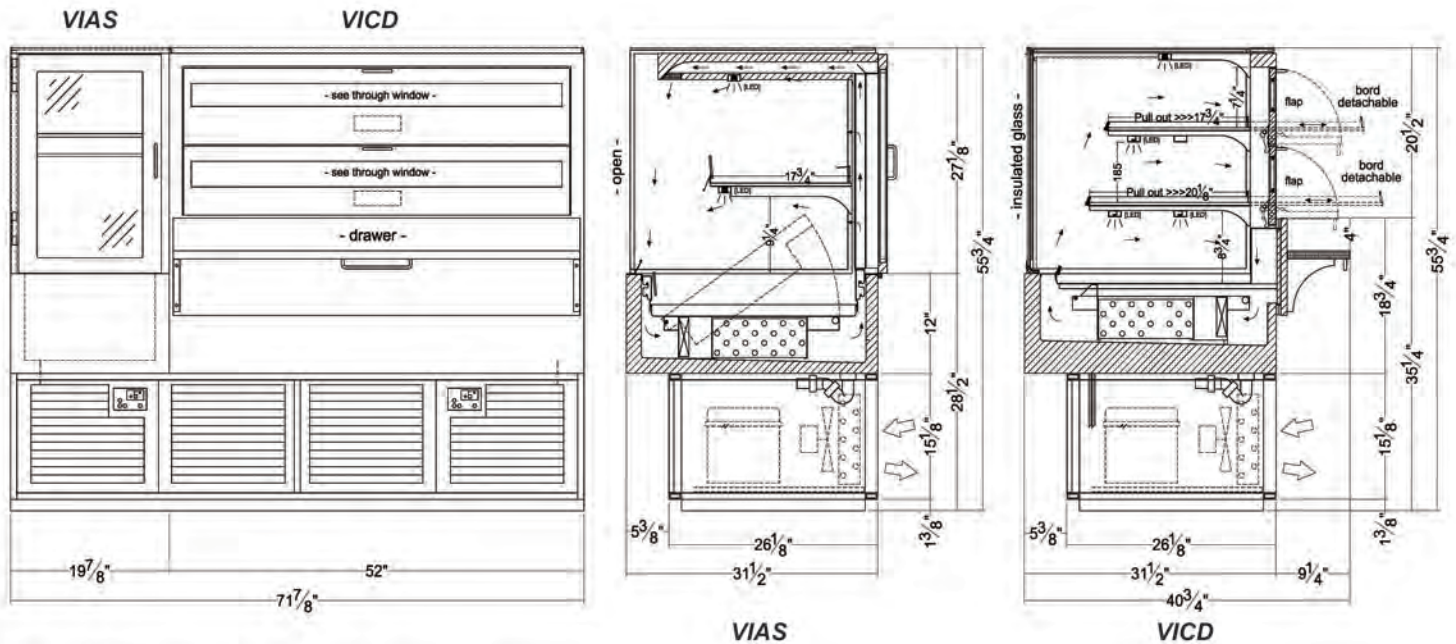

Electrical & Plumbing locations

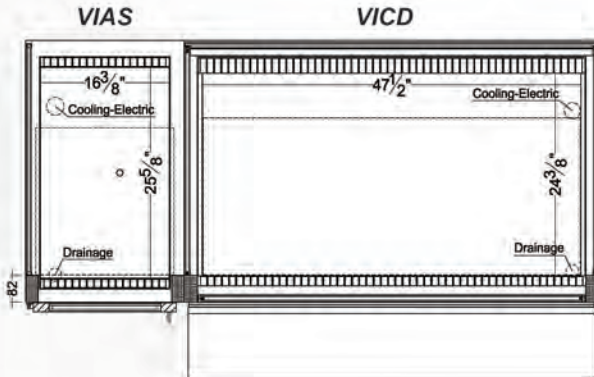

1. A 1 1/8" diameter drain is provided. The drain **MUST** be connected to a floor drain or storage container **AT TIME OF INSTALLATION**.
2. For self-contained units, ventilation louvers, **MUST** be provided in the cabinet or counter and located so to provide full ventilation for the condensing unit.
3. For remote units, customer must verify refrigerant at the time of order to ensure proper expansion valve is provided.
4. The VIAS+VICD INS merchandiser is designed for use in locations where temperatures and humidity do not exceed 75 degrees and 55% R.H. Locate away from direct sunlight, rapid air currents and extreme temperature changes. Exposure to air currents from ceiling fans, air conditioners, ovens, etc. will disrupt the cases air current and refrigeration zone within. Any adverse field conditions stated above will void warranty.

RPI in line with it's policy to continually improve it's product reserves the right to change materials and specifications without notice.

CALL TOLL FREE: 800-525-3692 (609-714-2330)

FAX: 609-714-2331 www.rpiindustries.com

220 ROUTE 70, MEDFORD, NJ 08055

RPI INDUSTRIES, INC. v10_19_23