

MODEL # SCMB-CD-FD

SPECIFICATIONS

A Monarch refrigerated display case with a grab & go bottom section, and a unique ambient upper self-service section that makes use of Plexi flip-up access doors, solid top ends, all presented in a squared format!



Available lengths: 36" 48" 60" 72"
 Available depths: 35 3/4"
 Available heights: 60"

STANDARD FEATURES

- Self-Contained Refrigeration
- Standard Grade Laminate Exterior
- Mirrored Interior Ends
- Black Base
- **Upper Section**
 - Dry Self-Service
 - Flip-up Plexiglass Doors
 - LED Top Canopy Light
 - (1) Tempered Glass Shelves
 - White Laminated Deck
 - See-Through Mirrored Rear Sliding Doors
- **Bottom Section**
 - Refrigerated Self-Service
 - LED Top Canopy Light
 - Stainless Steel Perforated Interior Back Panel
 - Removable Stainless Steel Deck Pan(s) with Hemmed Edge to Contain Spills
- Thermometer
- 8' Cord and Plug
- ETL Listed in Accordance with UL 471 and NSF 7 Standards
- Environmentally Safe Refrigerant
- 1 Year Parts and Labor Warranty
- Built in condensate evaporation system
- 5 Year Compressor Warranty

OPTIONAL FEATURES

- Remote Refrigeration
- Stainless Steel Exterior Finish
 - #4 #6 #8
- Special Laminates
- Wood Veneers (Unfinished)
- Wood Veneers (Stained & Sealed)
- Miscellaneous Trim
- Black Styrene Step Sham (Bottom Section)
- Stainless Steel Step Sham (Bottom Section)
- Casters (Increases Height by 4")
- Adjustable Legs (Consult Factory for Sizes)
- Powder Coated Interior Back Panel and Hardware
 - Black White
- Mirrored Polished Stainless Steel Interior Ends (#8 Finish)
- Mirrored Polished Stainless Steel Interior Back Panel (#8 Finish)
- Stainless Steel Laminated Deck (Upper Section)
- Glass Vision End Panels (Upper Section)
- Pull Down #23 Econo Frost Night Curtain (Bottom Section)
- Removable Locking Security Panels (Bottom Section)
- Rear Door Locks (Lower Section)



MODEL # SCMB-CD-FD

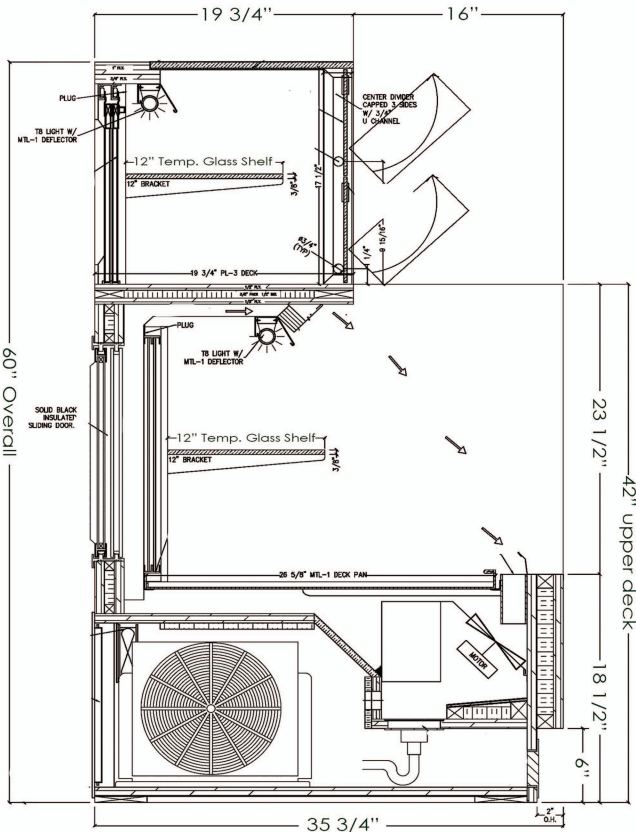

SELF - CONTAINED

MODEL	L	D	H	HP	VOLT	AMP	PLUG	WT	REFRIG.
SCMB36R-CD-FD	36	35 3/4	60	1/2	115	15.1	5-20P	700	134A
SCMB48R-CD-FD	48	35 3/4	60	1/2	115	15.1	5-20P	800	134A
SCMB60R-CD-FD	60	35 3/4	60	3/4	115/208-230	14	L14-20P	925	404A
SCMB72R-CD-FD	72	35 3/4	60	3/4	115/208-230	14.5	L14-20P	1100	404A

* 448a refrigeration available at no additional cost - please specify

REMOTE - REFRIGERATED

MODEL	BTU @ 20°F	VOLT	AMP	PLUG	WT	REFRIG.
SCMB36R-RR-CD-FD	4140	115	10.5	5-15P	600	Verify
SCMB48R-RR-CD-FD	4140	115	10.6	5-15P	750	Verify
SCMB60R-RR-CD-FD	7470	115	10.6	5-15P	875	Verify
SCMB72R-RR-CD-FD	7470	115	11.5	5-15P	1000	Verify

* All electric requirements include a condensate evaporator pan.

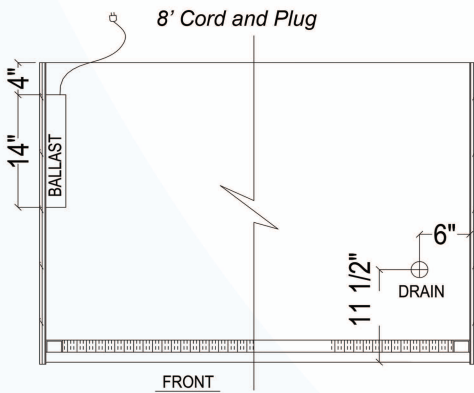

Electrical & Plumbing locations



Conforms to UL Standard 471, and NSF Standard 7; Certified To CSA Standard C22.2 No. 120

RPI refrigerated merchandisers configured for sale for use in the United States meet or surpass the requirements of the DOE 2017 energy efficiency standards

The SCMB-CD-FD merchandiser is designed for use in stores where temperature and humidity do not exceed 75 degrees F and 55% R. H. Locate away from direct sunlight, rapid air currents and extreme temperature changes, Exposure to air currents from ceiling fans, air conditioners, ovens, etc. will disrupt the case's air curtain and refrigerated zone within. Any adverse field conditions stated above will void warranty.

RPI in line with it's current policy to continually improve it's product reserves the right to change materials and specifications without notice.

CALL TOLL FREE: 800-525-3692 (609-714-2330)
 FAX: 609-714-2331 www.rpiindustries.com
 220 ROUTE 70, MEDFORD, NJ 08055

