

MODEL # SCMB

SPECIFICATIONS

The Monarch SCMB Series is a refrigerated display case with a choice of standard grade plastic laminate exterior ends and with flat fixed flat front insulated glass.

Available in refrigerated or non-refrigerated.

Available lengths: 35" 47" 59" 71" 95"

Available depths: 30" 35 3/4"

Available heights: 50"



STANDARD FEATURES

- Remote Refrigeration
- Fixed Flat Front Insulated Glass
- Standard Grade Laminate Exterior
- Black Base
- Mirrored Interior Vision End Panels
- White Laminated Deck
- LED Top Canopy Light
- (3) Tempered Glass Shelves with LED Lights
- See-Through Mirrored Rear Sliding Doors
- Thermometer
- 8' Cord and Plug
- ETL Listed in Accordance with UL 471 and NSF 7 Standards
- Environmentally Safe Refrigerant
- 1 Year Parts and Labor Warranty
- Floor Drain Required
- 5 Year Compressor Warranty

OPTIONAL FEATURES

- Stainless Steel Exterior Finish
 - #4 #6 #8
- Special Laminates
- Wood Veneers (Unfinished)
- Wood Veneers (Stained & Sealed)
- Miscellaneous Trim
- Brass Trim and Hardware
- Wire Shelves
 - Brass White Black Chrome
- Casters (Increases Height by 4")
- Adjustable Legs (Consult Factory for Sizes)
- Mirrored Polished Stainless Steel Interior Ends (#8 Finish)
- Stainless Steel Laminated Deck
- Rear Door Locks
- 8" Wrap Board
- Corian® Surface Top
- Granite Surface Top



MODEL # SCMB

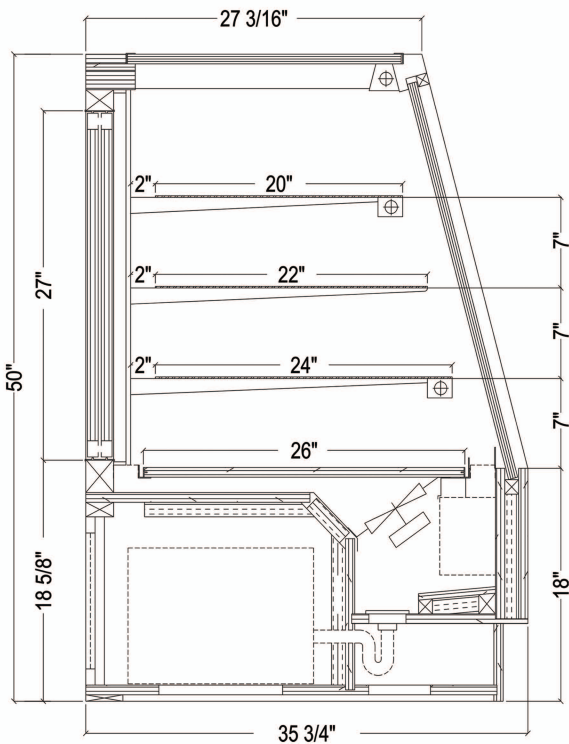

AMBIENT

MODEL	L	D	H	VOLT	AMP	PLUG	WT
SCMB36D	35	30-35 3/4	50	115	.5	5-15P	325
SCMB48D	47	30-35 3/4	50	115	.6	5-15P	450
SCMB60D	59	30-35 3/4	50	115	.7	5-15P	550
SCMB72D	71	30-35 3/4	50	115	.8	5-15P	700
SCMB96D	95	30-35 3/4	50	115	1.0	5-15P	900

REMOTE - REFRIGERATED

MODEL	BTU @ 20° F	VOLT	AMP	PLUG	WT	REFRIG.
SCMB36R-RR	1890	115	1.6	5-15P	475	Verify
SCMB48R-RR	2360	115	1.8	5-15P	625	Verify
SCMB60R-RR	2360	115	1.9	5-15P	660	Verify
SCMB72R-RR	4140	115	2.7	5-15P	940	Verify
SCMB96R-RR	4140	115	3.5	5-15P	1020	Verify

GLYCOL

MODEL	BTU @ 20° F	VOLT	AMP	PLUG	WT	GPM	REFRIG.
SCMB36R-RR-GL	1890	115	1.6	5-15P	475	.5	GLYCOL
SCMB48R-RR-GL	2360	115	1.8	5-15P	625	.59	GLYCOL
SCMB60R-RR-GL	2360	115	1.9	5-15P	660	.59	GLYCOL
SCMB72R-RR-GL	4140	115	2.7	5-15P	940	1.0	GLYCOL

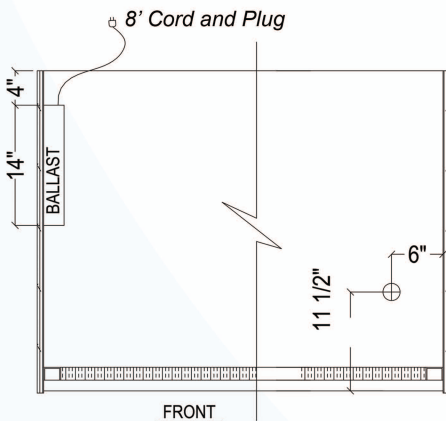

Electrical & Plumbing locations



Conforms to UL Standard 471,
and NSF Standard 7; Certified
To CSA Standard C22.2 No.120



RPI refrigerated merchandisers configured for sale for use in the United States meet or surpass the requirements of the DOE 2017 energy efficiency standards

1. All Remote and Glycol units must be run to a floor drain at time of installation.
 2. The SCMB merchandiser is designed for use in stores where temperature and humidity do not exceed 75 degrees F and 55% R.H. Locate away from direct sunlight, rapid air currents and extreme temperature changes. Any adverse field conditions stated above will void warranty.
- RPI in line with it's current policy to continually improve it's product reserves the right to change materials and specifications without notice.

CALL TOLL FREE: 800-525-3692 (609-714-2330)
FAX: 609-714-2331 www.rpiindustries.com
220 ROUTE 70, MEDFORD, NJ 08055

RPI INDUSTRIES, INC. v8_31_17