

MODEL # SCAS-DI-II

SPECIFICATIONS

The Olympus II Drop-In Air Screen SCAS-DI-II Series is a grab and go style refrigerator. The self-contained refrigeration system includes digital controls. Unit comes standard with 2 adjustable shelves, with energy efficient LED lighting underneath shelving.

Unit is designed to drop or slide into a counter.

Available lengths: 36" 48" 72"

Available depths: 26" 60"

Available heights: 68 1/2"



STANDARD FEATURES

- DOE 2017 Compliant
- Self-Contained Refrigeration
- Squared Top Canopy
- Metal Framed Base Construction with Compressor Housing
- Standard Grade Laminate Exterior
- Brushed Stainless Steel Interior Ends
- Stainless Steel Perforated Interior Back Panel
- LED Top Canopy Light
- (2) Adjustable Stainless Steel Shelves with LED Lights
- Removable Stainless Steel Deck with Hemmed Edge to Contain Spills
- Energy Efficient #23 Pull-Down Night Curtain
- Red Indicator Light Alerts Operator if Condenser Requires Cleaning
- Electronic Digital Control and Defrost Termination
- Digital Temperature Display
- Unique Interior Baffle Design for Compressor Noise Reduction
- 8' Cord and Plug
- ETL Listed in Accordance with UL 471 and NSF 7 Standards
- Conforms to NSF STD 7 Type II Refrigeration
- Environmentally Safe Refrigerant
- 1 Year Parts and Labor Warranty
- Floor Drain Required
- Thermometer
- 5 Year Compressor Warranty

OPTIONAL FEATURES

- Remote Refrigeration
- Special Laminates
- Wood Veneers (Stained & Sealed)
- Miscellaneous Trim
- Wire Shelves
 - Brass White Black Chrome
- Mirrored Polished Stainless Steel Shelves (#8 Finish)
- U Shape Front Shelf Merchandiser
- Adjustable Legs (Consult Factory for Sizes)
- Powder Coated Interior Back Panel and Hardware
 - Black White Custom Color
- Mirrored Polished Stainless Steel Interior Ends (#8 Finish)
- Mirrored Polished Stainless Steel Perforated Interior Back Panel (#8 Finish)
- Finished Back
- Solid Insulated or See-Through Rear Doors
 - 36" Hinged Door 48", 60", 72" Sliding Door
- Insulated Glass Vision End Panels
- Removable Locking Security Panels
- Roll Down Locking Security Cover

CALL TOLL FREE: 800-525-3692 (609-714-2330)

FAX: 609-714-2331 www.rpiindustries.com

220 ROUTE 70, MEDFORD, NJ 08055

MODEL # SCAS-DI-II

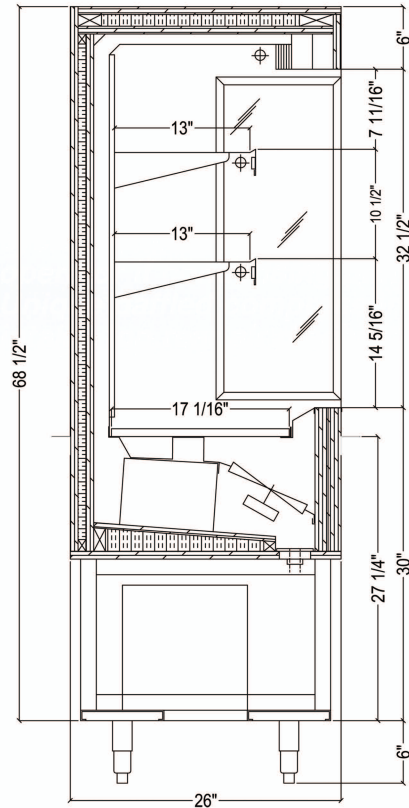

UNIT SHOWN WITH OPTIONAL SIDE GLASS PANEL

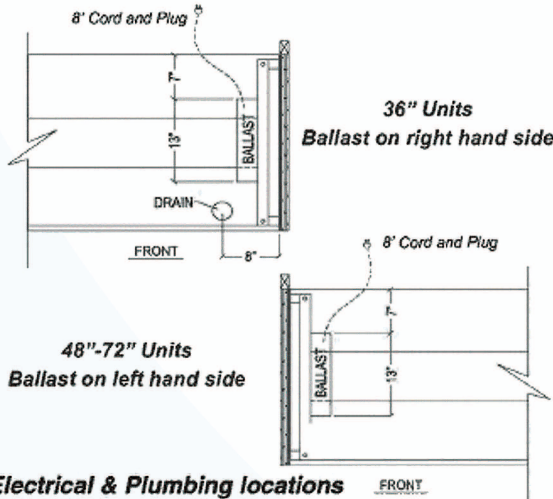

Electrical & Plumbing locations

SELF CONTAINED

MODEL	L	D	H	HP	VOLT	AMP	PLUG	WT	REFRIG.
SCAS36R-DI-II	36	26	68 1/2	1/2	115	12.8	5-20P	700	134A
SCAS48R-DI-II	48	26	68 1/2	3/4	115/208-230	11.4	L14-30P	900	404A
SCAS60R-DI-II	60	26	68 1/2	1 1/4	115/208-230	12.4	L14-30P	1100	404A
SCAS72R-DI-II	72	26	68 1/2	1 1/4	115/208-230	13.2	L14-30P	1300	404A

AMBIENT

MODEL	L	D	H	VOLT	AMP	PLUG	WT
SCAS36D-DI-II	36	26	68 1/2	115	0.40	5-15P	650
SCAS48D-DI-II	48	26	68 1/2	115	0.52	5-15P	800
SCAS60D-DI-II	60	26	68 1/2	115	0.65	5-15P	1000
SCAS72D-DI-II	72	26	68 1/2	115	0.78	5-15P	1200

REMOTE - REFRIGERATED

MODEL	BTU @ 20 F	VOLT	AMP	PLUG	WT	REFRIG.
SCAS36R-DI-II-RR	4140	115	1.32	5-15P	650	Verify
SCAS48R-DI-II-RR	7470	115	1.86	5-15P	800	Verify
SCAS60R-DI-II-RR	9960	115	2.0	5-15P	1000	Verify
SCAS72R-DI-II-RR	9960	115	2.25	5-15P	1200	Verify

* 448a refrigeration available at no additional cost - please specify

GLYCOL

MODEL	BTU @ 20 F	VOLT	AMP	PLUG	WT	GPM	REFRIG.
SCAS36R-DI-II-RR-GL	4140	115	1.32	5-15P	650	1.0	GLYCOL
SCAS48R-DI-II-RR-GL	7470	115	1.86	5-15P	800	1.5	GLYCOL
SCAS60R-DI-II-RR-GL	9960	115	2.0	5-15P	1000		GLYCOL
SCAS72R-DI-II-RR-GL	9960	115	2.25	5-15P	1200		GLYCOL

NOTE: Due to horsepower requirements, noise levels can reach 75 DB's. Please verify location. Tile floors, low ceilings, small rooms or multiple self-contained units will elevate the noise level. Remote refrigeration is recommended.

*34" high cabinets require 6" adjustable stainless steel legs

*36" high cabinets require 8" adjustable stainless steel legs



Conforms to UL Standard 471, and NSF Standard 7; Certified To CSA Standard C22.2 No.120

Conforms to NSF STD 7
TYPE II

DOE 2017
Energy Efficiency
Compliant

RPI refrigerated merchandisers configured for sale for use in the United States meet or surpass the requirements of the DOE 2017 energy efficiency standards

1. All Self-Contained Remote and Glycol Units must be run to a floor drain at time of installation.
2. Refrigeration System is designed so air will flow front to rear. Unobstructed air flow must be maintained to ensure unit performance and maintain warranty.
3. The SCAS-DI-II merchandiser is designed for use in stores where ambient temperatures and humidity do not exceed 80 Degrees Fahrenheit and 60% R.H. Locate away from direct sunlight, rapid air currents and extreme temperature changes. Exposure to air currents from ceiling fans, air conditioning diffusers, ovens, etc. will disrupt the case air curtain and refrigerated zone. Refrigerated Displays are designed to maintain pre-chilled products. Adding or loading warm products above 41 Degrees Fahrenheit can affect the temperature in the entire cabinet. Any adverse field conditions stated above will void warranty.

RPI in line with its policy to continually improve its products reserves the right to change materials and specifications without notice.

CALL TOLL FREE: 800-525-3692 (609-714-2330)

FAX: 609-714-2331 www.rpiindustries.com

220 ROUTE 70, MEDFORD, NJ 08055

RPI INDUSTRIES, INC. v2_26_24