

# OLYMPUS III MILK CRATE AIR SCREEN

PROJECT: \_\_\_\_\_

ITEM: \_\_\_\_\_ QUANTITY: \_\_\_\_\_

## MODEL # SCAS-III MC

### SPECIFICATIONS

The Olympus Milk Case SCAS-III MC Series is a grab and go style air screen refrigerator with slide-in accessibility behind tray rails or die walls. Unit features large heated hinged glass doors in rear for easy placement of milk crates onto the heavy duty s/s deck pan. Top mount compressor enables recessed deck to accommodate milk crates. Unit comes standard with exterior laminate finish, and is available with energy efficient LED lighting underneath shelving.



Available lengths:  36"  48"  60"  72"

Available depths:  29 3/4"

Available heights:  91"

### STANDARD FEATURES

- Top Mount Self-Contained Refrigeration
- Metal Frame Base Construction
- Standard Grade Plastic Laminate Exterior
- Brushed Stainless Steel Interior Ends
- Tuff Act Plexi Rear Interior Panel
- LED Top Canopy Light
- (3) 3/8" Tempered Glass Shelves, LED Lights
- Removable Stainless Steel Deck Pan with Hemmed Edge to Contain Spills
- Lockable Hinged Rear See-Through Heated Doors
- Heated Glass Vision End Panels
- Roll Down Locking Security Cover
- Adjustable Legs
- 8' Cord and Plug
- ETL Listed in Accordance with UL 471 and NSF 7 Standards
- Environmentally Safe Refrigerant
- 1 Year Parts and Labor Warranty
- 5 Year Compressor Warranty
- Floor Drain Required

### OPTIONAL FEATURES

- Remote Refrigeration (Compressor Supplied and Installed by Others, Overall Height 75")
  - 2 Year Parts and Labor Warranty
  - Stainless Steel Exterior Finish
    - #4  #6  #8
  - Electric Condensate evap pan with pump
- NOTE: Separate 115v/60/1 15 amp circuit required for all 115v cases only



Conforms to UL Standard 471, and NSF Standard 7; Certified To CSA Standard C22.2 No.120

NOTE: UNIT SHOWN INSTALLED INTO A CUSTOM COUNTER WITH OPTIONAL STAINLESS STEEL EXTERIOR

CALL TOLL FREE: 800-525-3692 (609-714-2330)

FAX: 609-714-2331 [www.rpiindustries.com](http://www.rpiindustries.com)

220 ROUTE 70, MEDFORD, NJ 08055



INDUSTRIES, INC. v3\_4\_24

## MODEL # SCAS-III MC

**NOTE:** A minimum of 18" clearance needed above unit for air discharge for self contained units.

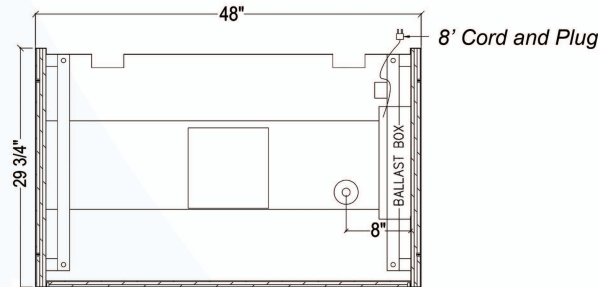
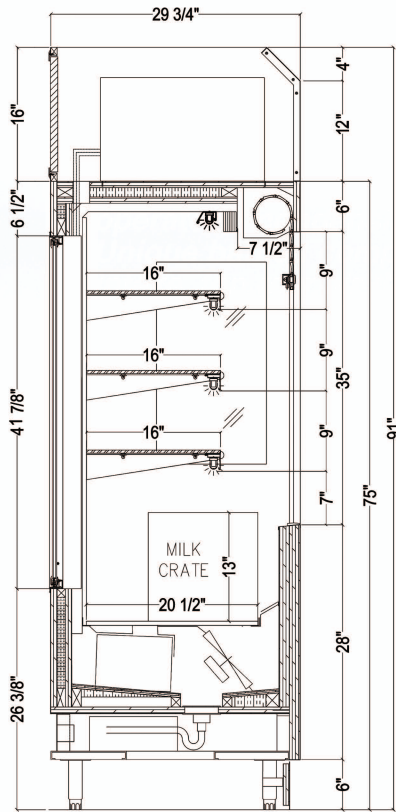

**Electrical & Plumbing locations**

## SELF - CONTAINED

MODEL	L	D	H**	HP	VOLT	AMP	PLUG	WT	REFRIG.
SCAS36R-III MC	36	29 3/4	91	1/2	115	12.8	5-20P	750	134A
SCAS48R-III MC	48	29 3/4	91	3/4	115/208-230 4 wire	11.4	L14-30P	975	404A
SCAS60R-III MC	60	29 3/4	91	1 1/4	115/208-230 4 wire	12.4	L14-30P	1095	404A
SCAS72R-III MC	72	29 3/4	91	1 1/4	115/208-230 4 wire	12.5	L14-30P	1225	404A

\* 448a refrigeration available at no additional cost - please specify

## REMOTE - REFRIGERATED

MODEL	BTU @ 20° F	VOLT	AMP	PLUG	WT	REFRIG.
SCAS36R-III-RR MC	4140	115	1.25	5-15P	700	Verify
SCAS48R-III-RR MC	7470	115	1.75	5-15P	875	Verify
SCAS60R-III-RR MC	9960	115	1.90	5-15P	995	Verify
SCAS72R-III-RR MC	9960	115	2.39	5-15P	1125	Verify

## GLYCOL

MODEL	BTU @ 20° F	VOLT	AMP	PLUG	WT	GPM	REFRIG.
SCAS36R-III-RR-GL MC	4140	115	1.25	5-15P	700	1.0	GLYCOL
SCAS48R-III-RR-GL MC	7470	115	1.75	5-15P	875	2.0	GLYCOL
SCAS60R-III-RR-GL MC	9960	115	1.90	5-15P	995	2.5	GLYCOL
SCAS72R-III-RR-GL MC	9960	115	2.39	5-15P	1125	2.5	GLYCOL

**NOTE:** Separate 115V/60/1 15 amp circuit required when adding evap pan and pump for all 115v cases



Conforms to UL Standard 471, and NSF Standard 7; Certified To CSA Standard C22.2 No.120

\*\* PLEASE NOTE: The 91" height will not fit through a standard doorway or truck-in upright position

1. All Self-Contained, Remote and Glycol Units must be run to a floor drain at time of installation
2. Refrigeration System is designed so air will flow front to rear. Unobstructed air flow must be maintained to ensure unit performance and maintain warranty.
3. The SCAS-III MC merchandiser is designed for use in stores where ambient temperatures and humidity do not exceed 75 Degrees Fahrenheit and 55% R.H. Locate away from direct sunlight, rapid air currents and extreme temperature changes. Exposure to air currents from ceiling fans, air conditioning diffusers, ovens, etc. will disrupt the case air curtain and refrigerated zone. Refrigerated Displays are designed to maintain pre-chilled products. Adding or loading warm products above 41 Degrees Fahrenheit can affect the temperature in the entire cabinet. Any adverse field conditions stated above will void warranty.

RPI in line with its policy to continually improve its products reserves the right to change materials and specifications without notice.