

MODEL # SCAS-V-PD-ME

SPECIFICATIONS

The SCAS-V-PD-ME Olympus Porte Cachee air screen is an open refrigerated merchandiser that offers a retractable insulated glass lockable pocket door system. This allows the unit to be utilized as a hinged door merchandiser during off peak hours with minimal energy consumption. Easy patented door-slide mechanism gives operator quick access to change from a glass door merchandiser to a fully open grab and go refrigerator.

- Available lengths: 48"
Available depths: 33 5/16"
Available heights: 78 1/2"



*Shown with optional header & chip rack

STANDARD FEATURES

- Self-Contained Refrigeration
- Squared Top Canopy
- Solid Contoured End Panels
- Top Bracket For Accomodating Header Panel
- Smart Controller Electronic Digital Temperature Control and Defrost Termination
- Metal Frame Base Construction with Lift-Out Black Louvered Air Grill For Easy Access To Compressor
- Standard Grade Laminate Exterior
- Brushed Stainless Steel Interior Ends
- Stainless Steel Perforated Interior Back Panel
- 4000K LED Top Canopy Light
- Vertical Recessed Power Supply For Undershelf Light
- 2 Position Down Slant Bracket For Tiltable Shelves
- (4) Adjustable Stainless Steel Shelves for Maximum Capacity, with 4000K LED Lighting
- Removable Stainless Steel Deck Pan with Hemmed Edge to Contain Spills
- Red Indicator Light Alerts Operator if Condenser Requires Cleaning
- Unique Internal Baffle Design for Compressor Noise Reduction
- Front Air Intake with Top Rear Air Discharge for Zero Clearance
- Easy Slide-Out Condensing Unit For Service
- 8' Cord and Plug
- One Set of (2) Lockable Insulated Front Hinged Pocket Doors
- ETL Listed in Accordance with UL 471 and NSF 7 Type II Refrigeration
- Environmentally Safe Refrigerant
- Built-in Condensate Evaporator System
- 1 Year Parts and Labor Warranty
- 5 Year Compressor Warranty

OPTIONAL FEATURES

- Squared End Profile (32" Deep)
- Side Vision End Panels
- Heated Insulated Glass Vision Panel
- Remote Refrigeration
- Front Decorative Panels (Remote Refrigerated Units Only, Consult Factory)
- Special Laminates
- Stainless Steel Exterior Finish
 - #4 #8
- Finished Back with Air Grill:
 - Stainless Steel Black
- Wood Veneers (Stained & Sealed)
- Tempered 3/8" Glass Shelving
- Casters:
 - 3" 6"
- Adjustable Legs Up To 6"
- Powder Coated Interior Back Panel and Hardware
 - Black White Custom Color
- Mirrored Polished Stainless Steel Interior Ends (#8 Finish)
- Mirrored Polished Stainless Steel Perforated Interior Back Panel (#8 Finish)
- Joining Kit Hardware
- Acrylic Product Stop For Stainless Steel Shelving
- 24" High Header Panel (Graphic By Others)
 - 16" High Lightbox Insert Header Laminate Header
 - Backlit Top Header



Conforms to UL Standard 471, and NSF Standard 7; Certified To CSA Standard C22.2 No.120

Conforms to NSF STD 7
TYPE II

DOE 2017
Energy Efficiency
Compliant

CALL TOLL FREE: 800-525-3692 (609-714-2330)

FAX: 609-714-2331 www.rpiindustries.com

220 ROUTE 70, MEDFORD, NJ 08055

RPI INDUSTRIES, INC. v3_18_24

MODEL # SCAS-V-PD-ME

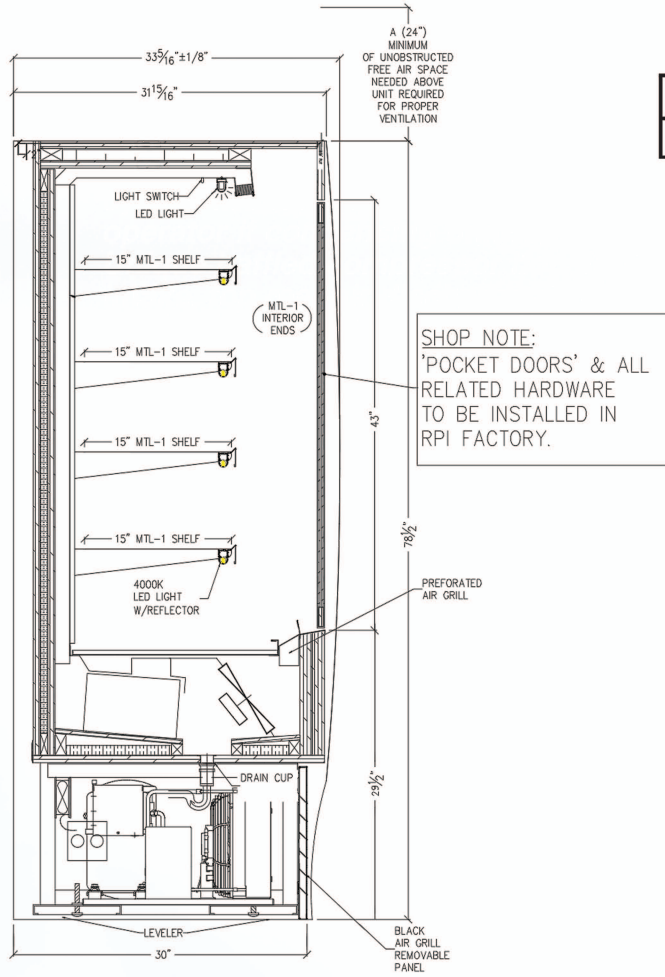

SHOP NOTE:
'POCKET DOORS' & ALL RELATED HARDWARE TO BE INSTALLED IN RPI FACTORY.

SELF - CONTAINED

MODEL	L	D	H	HP	VOLT	AMP	PLUG	WT	REFRIG.
SCAS48R-V-PD-ME	48	33 5/16	78 1/2	1	115/208-230 4 wire	15.8	L14-20P	900	404A

NOTE: A minimum of 24" unobstructed free air space required above unit / header panel if in line with a self contained refrigerated Market Express case.

REMOTE - REFRIGERATED

MODEL	BTUH @ 20 F	VOLT	AMP	PLUG	WT	REFRIG.
SCAS48R-V-PD-ME-RR	7470	115	10.6	5-15P	800	Verify

GLYCOL

MODEL	BTUH @ 20 F	VOLT	AMP	PLUG	WT	GPM	REFRIG.
SCAS48R-V-PD-ME-RR-GL	7470	115	10.6	5-15P	800	2.0	GLYCOL

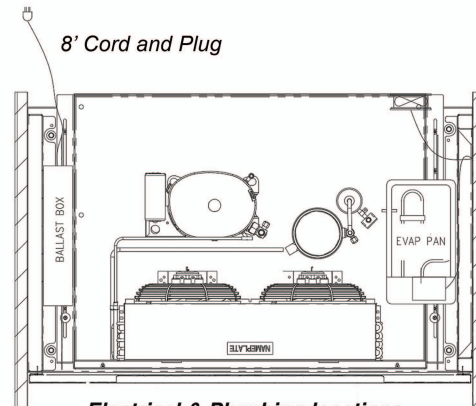

Electrical & Plumbing locations

HOW THE DOORS WORK

Doors attach to arm, that tracks along an interior rail system (A), top and bottom mounted hinges allow for opening/closing (B), this combined system allows for the pull-out doors, to 'Pocket-in' during peak hours (C & D)



 Conforms to UL Standard 471, and NSF Standard 7; Certified To CSA Standard C22.2 No.120

 Conforms to NSF STD 7

 DOE 2017 Energy Efficiency Compliant

RPI refrigerated merchandisers configured for sale for use in the United States meet or surpass the requirements of the DOE 2017 energy efficiency standards

1. Refrigeration System is designed so air will flow front to rear. Unobstructed air flow must be maintained to ensure unit performance and maintain warranty.
2. The SCAS-V-PD-ME merchandiser is designed for use in stores where ambient temperatures and humidity do not exceed 80 Degrees Fahrenheit and 60% R.H. Locate away from direct sunlight, rapid air currents and extreme temperature changes. Exposure to air currents from ceiling fans, air conditioning diffusers, ovens, etc. will disrupt the case air curtain and refrigerated zone. Refrigerated Displays are designed to maintain pre-chilled products. Adding or loading warm products above 41 Degrees Fahrenheit can affect the temperature in the entire cabinet. Any adverse field conditions stated above will void warranty.

RPI in line with its policy to continually improve its products reserves the right to change materials and specifications without notice.

CALL TOLL FREE: 800-525-3692 (609-714-2330)

FAX: 609-714-2331 www.rpiindustries.com

220 ROUTE 70, MEDFORD, NJ 08055