

## OVER/UNDER MODEL # SCCB-OU

### SPECIFICATIONS

The Continental Over / Under SCCB-OU Series is a two section refrigerated display case featuring a refrigerated operator serve lower section and a non-refrigerated service upper section. Available with a choice of standard grade plastic laminate exterior ends. The lower section has a lift-up laminated deck that can be removed for easy cleaning.



Available lengths:  36"  48"  60"  72"

Available depths:  35 3/4"

Available heights:  60"

### STANDARD FEATURES

- Remote Refrigeration
- Standard Grade Laminate Exterior
- Mirrored Interior End Panels
- Black Base
- **Upper Section**
  - Non-Refrigerated Full Service
  - Fixed Curved Front Glass
  - LED Top Canopy Light
  - (1) Tempered Glass Shelf with LED Light
  - Stainless Steel Laminated Deck
  - See-Through Mirrored Rear Sliding Doors
- **Bottom Section**
  - Refrigerated Full Service
  - Fixed Flat Front Insulated Glass
  - LED Top Canopy Light
  - (2) Tempered Glass Shelves with LED Lights
  - Removable White Laminated Deck
  - See-Through Mirrored Rear Sliding Doors
- Thermometer
- 8' Cord and Plug
- ETL Listed in Accordance with UL 471 and NSF 7 Standards
- Environmentally Safe Refrigerant
- 1 Year Parts and Labor Warranty
- Floor Drain Required

### OPTIONAL FEATURES

- Stainless Steel Exterior Finish
  - #4  #6  #8
- Special Laminates
- Wood Veneers (Unfinished)
- Wood Veneers (Stained & Sealed)
- Miscellaneous Trim
- Brass Trim and Hardware
- Wire Shelves
  - Brass  White  Black  Chrome
- Casters (Increases Height by 4")
- Adjustable Legs (Consult Factory for Sizes)
- Mirrored Polished Stainless Steel Interior Ends (#8 Finish)
- Removable Stainless Steel Laminated Deck (Bottom Section)
- Insulated Glass Vision End Panels (Upper Section)
- Rear Door Locks
- 8" Wrap Board

CALL TOLL FREE: 800-525-3692 (609-714-2330)

FAX: 609-714-2331 [www.rpiindustries.com](http://www.rpiindustries.com)

220 ROUTE 70, MEDFORD, NJ 08055



## OVER/UNDER MODEL # SCCB-OU

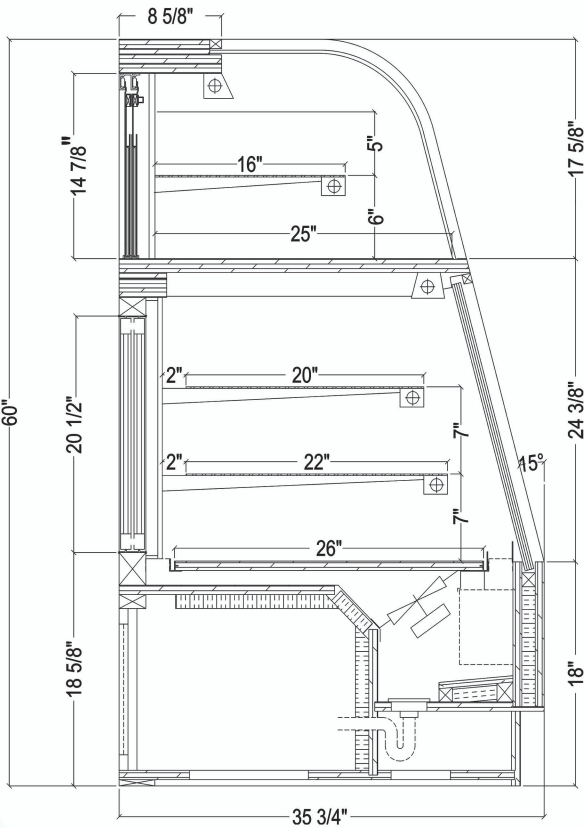

### SELF - CONTAINED

MODEL	L	D	H	VOLT	AMP	PLUG	WT	REFRIG.
SCCB36R-OU	36	32	78	115	7.90	5-15P	600	134A
SCCB48R-OU	48	32	78	115	9.49	5-15P	750	404A
SCCB60R-OU	60	32	78	115	9.72	5-20P	875	404A
SCCB72R-OU	72	32	78	115/208-230V	10.52	5-20P	1040	404A

### REMOTE - REFRIGERATED

MODEL	BTU @ 20° F	VOLT	AMP	PLUG	WT	REFRIG.
SCCB36R-OU-RR	1890	115	1.8	5-15P	600	Verify
SCCB48R-OU-RR	2360	115	1.9	5-15P	750	Verify
SCCB60R-OU-RR	2360	115	2.0	5-15P	875	Verify
SCCB72R-OU-RR	4140	115	2.8	5-15P	1040	Verify

\* 448a refrigeration available at no additional cost - please specify

### GLYCOL

MODEL	BTU @ 20° F	VOLT	AMP	PLUG	WT	GPM	REFRIG.
SCCB36R-OU-RR-GL	1890	115	1.8	5-15P	600	.5	GLYCOL
SCCB48R-OU-RR-GL	2360	115	1.9	5-15P	750	1.0	GLYCOL
SCCB60R-OU-RR-GL	2360	115	2.0	5-15P	875	1.0	GLYCOL
SCCB72R-OU-RR-GL	4140	115	2.8	5-15P	1040	1.0	GLYCOL

### Electrical & Plumbing locations

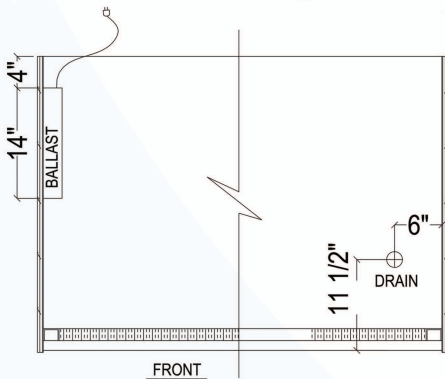

Conforms to UL Standard 471,  
and NSF Standard 7; Certified  
To CSA Standard C22.2 No.120



**RPI refrigerated merchandisers configured for sale for use in the United States meet or surpass the requirements of the DOE 2017 energy efficiency standards**

1. All Remote and Glycol units must be run to a floor drain at time of installation.
2. The SCCB-OU merchandiser is designed for use in stores where temperature and humidity do not exceed 75 degrees F and 55% R. H. Locate away from direct sunlight, rapid air currents and extreme temperature changes, Exposure to air currents from ceiling fans, air conditioners, ovens, etc. will disrupt the case's air curtain and refrigerated zone within. Any adverse field conditions stated above will void warranty.

RPI in line with it's current policy to continually improve it's product reserves the right to change materials and specifications without notice.

CALL TOLL FREE: 800-525-3692 (609-714-2330)

FAX: 609-714-2331 [www.rpiindustries.com](http://www.rpiindustries.com)

220 ROUTE 70, MEDFORD, NJ 08055