

MONACO COLD MODEL # SCXSSC

SPECIFICATIONS _____

The Express Monaco Cold SCXSSC Series is a self-select refrigerated open air display case with choice of standard grade plastic laminate exterior ends and features a 12" wide stainless steel work surface. Optional stainless steel exterior finish, special laminates and wood veneers are also available, with a choice of casters or adjustable legs.



Available lengths: 47 3/8" 59 3/8" 71 3/8" *
 Available depths: 43 7/8"
 Available heights: 37 1/8"

STANDARD FEATURES

- Self-Contained Refrigeration
- Standard Grade Laminate Exterior
- Black Base
- 3/8" Plexi Glass Front and Side Panels
- Rear Stainless Steel Work Ledge with Zip Lite Cutting Board
- Brushed Aluminum Interior Ends
- Stainless Steel Interior Perforated Back Panel
- Stainless Steel Deck Pan
- Thermometer
- 8' Cord and Plug
- ETL Listed in Accordance with UL 471 and NSF 7 Standards
- Environmentally Safe Refrigerant
- 1 Year Parts and Labor Warranty
- Floor Drain Required
- 5 Year Compressor Warranty

OPTIONAL FEATURES

- Remote Refrigeration
- Stainless Steel Exterior Finish
 - #4 #6 #8
- Special Laminates
- Wood Veneers (Unfinished)
- Wood Veneers (Stained & Sealed)
- Miscellaneous Trim
- Black Styrene Step Sham
- Stainless Steel Step Sham
- Casters (Increases Height by 4")
- Adjustable Legs (Consult Factory for Sizes)
- Mirrored Polished Stainless Steel Interior Ends (#8 Finish)
- Mirrored Polished Stainless Steel Perforated Interior Back Panel (#8 Finish)
- Extended Height Glass Front and Side Panels
- Corian® Rear Work Ledge
- Zodiac® Rear Work Ledge

* 72 INCH (71 3/8") LENGTHS AVAILABLE IN REMOTE REFRIG. ONLY

CALL TOLL FREE: 800-525-3692 (609-714-2330)

FAX: 609-714-2331 www.rpiindustries.com

220 ROUTE 70, MEDFORD, NJ 08055



EXPRESS SELF SELECT

MONACO COLD MODEL # SCXSSC

PROJECT: _____

TOLL FREE: 800-525-3692

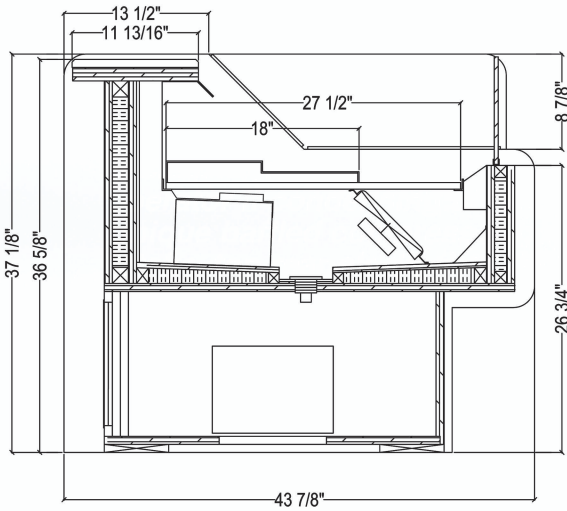

UNIT SHOWN WITH OPTIONAL 18" STEP SHAM

Electrical & Plumbing locations

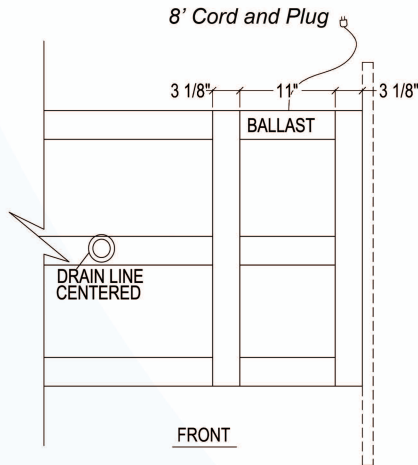

SELF - CONTAINED

MODEL	L	D	H	HP	VOLT	AMP	PLUG	WT	REFRIG.
SCXSSC48R	47 3/8	43 7/8	37 1/8	1/3	115	9.1	5-15P	375	134A
SCXSSC60R	59 3/8	43 7/8	37 1/8	1/2	115	12.0	5-15P	460	134A

* 448a refrigeration available at no additional cost - please specify

REMOTE - REFRIGERATED

MODEL	BTU @ 20° F	VOLT	AMP	PLUG	WT	REFRIG.
SCXSSC48R-RR	2360	115	1.3	5-15P	325	Verify
SCXSSC60R-RR	4140	115	1.3	5-15P	410	Verify
SCXSSC72R-RR *	7470	115	2.0	5-15P	500	Verify

* 72 INCH (71 3/8") LENGTHS AVAILABLE IN REMOTE REFRIG. ONLY

GLYCOL

MODEL	BTU @ 20° F	VOLT	AMP	PLUG	WT	GPM	REFRIG.
SCXSSC48R-RR-GL	2360	115	1.3	5-15P	325	.59	GLYCOL
SCXSSC60R-RR-GL	4140	115	1.3	5-15P	410	1.0	GLYCOL
SCXSSC72R-RR-GL	7470	115	2.0	5-15P	500	2.0	GLYCOL



Conforms to UL Standard 471,
and NSF Standard 7; Certified
To CSA Standard C22.2 No.120



RPI refrigerated merchandisers configured for sale for use in the United States meet or surpass the requirements of the DOE 2017 energy efficiency standards

1. All Self-Contained, Remote and Glycol Units must be run to a floor drain at time of installation.
2. Refrigeration System is designed so air will flow front to rear. Unobstructed air flow must be maintained to ensure unit performance and maintain warranty.
3. The SCXSSC merchandiser is designed for use in stores where ambient temperatures and humidity do not exceed 75 degrees F and 55% R.H. Locate away from direct sunlight, rapid air currents and extreme temperature changes. Exposure to air currents from ceiling fans, air conditioning diffusers, ovens, etc. will disrupt the case air curtain and refrigerated zone. Refrigerated Displays are designed to maintain pre-chilled products. Adding or loading warm products above 41 Degrees Fahrenheit can affect the temperature in the entire cabinet. Any adverse field conditions stated above will void warranty.

RPI in line with its policy to continually improve its products reserves the right to change materials and specifications without notice.

CALL TOLL FREE: 800-525-3692 (609-714-2330)

FAX: 609-714-2331 www.rpiindustries.com

220 ROUTE 70, MEDFORD, NJ 08055

RPI INDUSTRIES, INC. v5_26_23