

# VIENNA WINE DISPLAY

## MODEL # VICD-68-R-SQ-SC

PROJECT: \_\_\_\_\_

ITEM: \_\_\_\_\_ QUANTITY: \_\_\_\_\_

### SPECIFICATIONS

The Vienna Series VICD2-68-R-SQ-SC is a two door self contained display with independent temperature control settings for each door allowing for presentation of red and white wines. A modular design allowing for integration of multiple units placed side by side. Stainless steel exterior with mirrored polished door frames, and interior vertical LED lighting. Available in self contained or remote refrigeration and with different racking styles.

Floor drains required.

Available lengths:  26 3/8"  52 3/4"

Available depths:  28 1/8"

Available heights:  87"



Double unit shown as remote with WKS racking

### STANDARD FEATURES

- Self-Contained Refrigeration
- Stainless steel #4 exterior of front, sides and rear
- Stainless steel door handles
- Insulation glass sides
- Energy saving thermal glass panes
- Solid rear with mirrored interior
- Front Door locks
- Removable Shelving (10 stainless WKS racks)
- Dual temperature zones (Double units only)
- Energy efficient LED lighting with dimmer
- Programmable digital display controller
- ETL listed in accordance with UL 471 and NSF 7 standards
- Environmentally safe refrigerant
- 5 Year Compressor Warranty
- Floor Drain Required

### OPTIONAL FEATURES

- Remote Refrigeration
- Insulated glass back wall
- Solid ends with mirrored interior
- Stainless steel #8 interior
- Stainless steel #8 exterior door frames with glass pane
- Exterior powder coating
- Interior powder coated shelves
- Slide out shelving to maximize bottle capacity
- Mirrored polished wine racks
- Various racking styles (contact factory)
- Stainless steel adjustable legs / casters

#### Optional Racking Styles

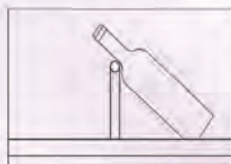

STYLE 1



STYLE 2

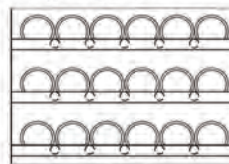

STYLE 3

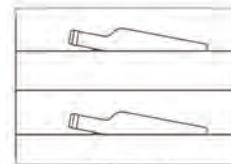

STYLE 4

#### SELF-CONTAINED

MODEL	L	D	H	VOLT	AMP	PLUG	WT	REFRIG.
VICD1-68-R-SQ-SC	26 3/8	28 1/8	87	115	4.2	5-15P	529	R448A
VICD2-68-R-SQ-SC	52 3/4	28 1/8	87	115	2x 4.2	5-15P	1058	R448A

#### REMOTE REFRIGERATED

MODEL	L	D	H	BTU's	VOLT	AMP	PLUG	WT	REFRIG.
VICD1-68-R-SQ-RR	26 3/8	28 1/8	87	1265 @ 14 Degs evap	115	1.0	5-15P	496	R448A
VICD2-68-R-SQ-RR	52 3/4	28 1/8	87	2x 1265 @ 14 Degs evap	115	2x 1.0	5-15P	992	R448A

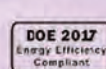

Conforms to UL Standard 471, and NSF Standard 7; Certified To CSA Standard C22.2 No.120

CALL TOLL FREE: 800-525-3692 (609-714-2330)

FAX: 609-714-2331 [www.rpiindustries.com](http://www.rpiindustries.com)

220 ROUTE 70, MEDFORD, NJ 08055



INDUSTRIES, INC. v10\_19\_23



# VIENNA WINE DISPLAY

## MODEL # VICD-68-R-SQ-SC

**PROJECT:** \_\_\_\_\_  
**TOLL FREE: 800-525-3692**

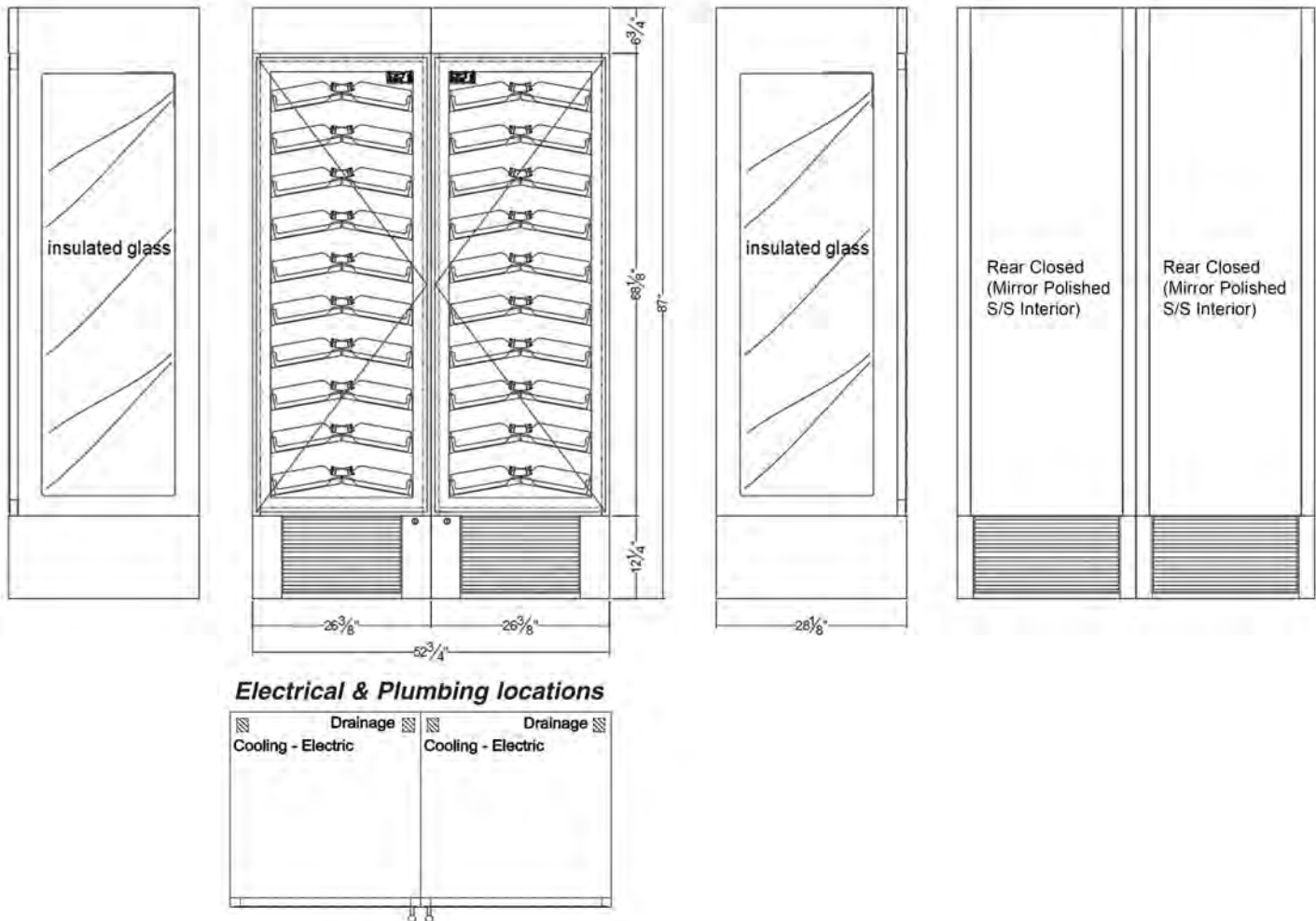

Bottle capacity: 130 (per door section)

Contact factory to discuss alternate racking options if you need more or less bottle capacity or want to use a variety of bottle displays.

1. A 1 1/8" diameter drain is provided. The drain **MUST** be connected to a floor drain or storage container **AT TIME OF INSTALLATION**.
2. For self-contained units, ventilation louvers **MUST** be provided in the cabinet or counter and located so to provide full ventilation for the condensing unit.
3. For remote units refrigerant must be verified by customer at the time of order to ensure proper expansion valve is provided.
4. The VICD2 merchandiser is designed for use in locations where temperatures and humidity do not exceed 75 degrees and 55% R.H. Unit is designed for air flow from front to rear and requires a minimum of 7" clearance behind and above unit. Locate away from direct sunlight, rapid air currents and extreme temperature changes. Exposure to air currents from ceiling fans, air conditioners, ovens, etc. will disrupt the cases air current and refrigeration zone within. Any adverse field conditions stated above will void warranty.

RPI in line with it's policy to continually improve it's product reserves the right to change materials and specifications without notice.

CALL TOLL FREE: 800-525-3692 (609-714-2330)

FAX: 609-714-2331 [www.rpiindustries.com](http://www.rpiindustries.com)

220 ROUTE 70, MEDFORD, NJ 08055

**RPI** INDUSTRIES, INC. v10\_19\_23