

## MODEL # VIHD-SQ-INS-CT SQUARED GLASS

### SPECIFICATIONS

The Vienna Series VIHD-SQ-INS-CT is a heated service air style unit designed for counter top application, featuring a tempered square glass profile with two tiers of product on display. Units are standard in stainless steel with an adjustable shelf, LED lights, infrared heat lamps and sliding rear see-through access doors.



Available lengths: ☐ 31 1/2"  
 Available depths: ☐ 23 5/8"  
 Available heights: ☐ 28 3/8"



Conforms to UL Standard 197,  
 and NSF Standard 4; Certified  
 To CSA Standard C22.2 No.109

### STANDARD FEATURES

- Squared Glass Profile
- 304 Stainless Steel Exterior
- Tempered Glass Top and Front Insulated Side Glass Panels
- Sliding Rear See-Through Access Doors
- (1) Black Glass Shelf with Light
- (2) Infrared Heat Lamps
- Easy Removable Deck Pan for Cleaning
- Rear Mounted Controller Switch
- 6' Cord and Plug
- ETL Listed in Accordance with UL 197 and NSF 4 Standards

### OPTIONAL FEATURES

- ☐ Mirrored Sliding Rear Access Doors
- ☐ Rear Door Locks

MODEL	L	D	H	VOLT	AMP	PLUG	WT
VIHD2-20-R-SQ-INS-CT	31 1/2	23 5/8	28 3/8	208-230	5.4	6-20P	440



CALL TOLL FREE: 800-525-3692 (609-714-2330)

FAX: 609-714-2331 [www.rpiindustries.com](http://www.rpiindustries.com)

220 ROUTE 70, MEDFORD, NJ 08055



INDUSTRIES, INC. v6\_16\_20

## MODEL # VIHD-SQ-INS-CT SQUARED GLASS

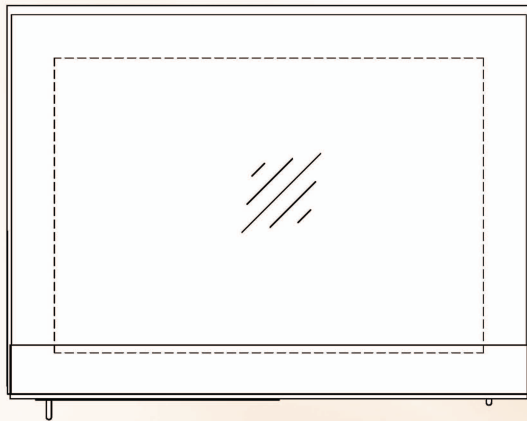
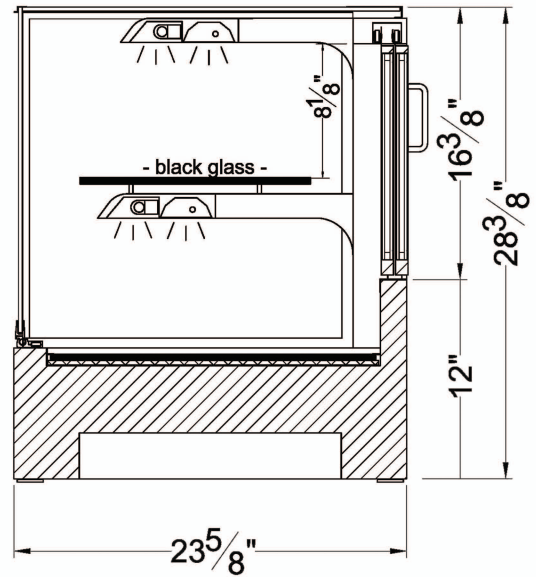
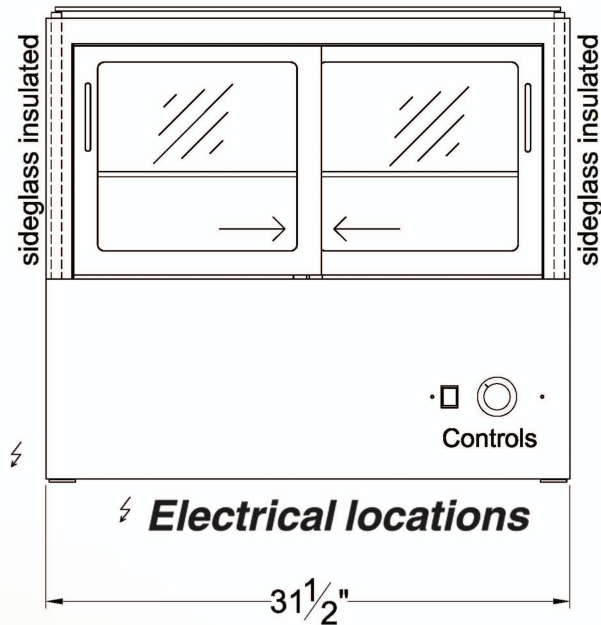

RPI in line with it's current policy to continually improve it's product reserves the right to change materials and specifications without notice.

CALL TOLL FREE: 800-525-3692 (609-714-2330)

FAX: 609-714-2331 [www.rpiindustries.com](http://www.rpiindustries.com)

220 ROUTE 70, MEDFORD, NJ 08055



INDUSTRIES, INC. v6\_16\_20