

MODEL # VSHC-INS

SPECIFICATIONS

The Vienna Series VSHC is a slide-in merchandiser in our Vienna Select Series that features the switchable option of either refrigerated or hot display. Designed to slide into a counter with the front stainless steel panel exposed. This merchandiser includes glass top that tilts up using gas-springs for support and tilt-out front glass for easy cleaning. It also features stainless steel exterior, top light and infrared heater, heating plate and sliding rear doors.

Available lengths: 35 7/8" 51 3/4"

Available depths: 40 1/8"

Available heights: 42 5/8"



STANDARD FEATURES

- 304 Stainless Steel Exterior
- Tempered Tilt-Up Top Glass
- Insulated Tilt-Out Front Glass
- Insulated Glass Side Panels
- Acrylic Glass Rear Sliding Doors
- Rear Cutting Board
- Top Canopy Light
- Infrared Heating Lamp (Hot Mode)
- Removable Black Glass Heating Plate with Variable Temperature Control (Hot Mode)
- Easy Removable Deck Pans for Cleaning (Cold Mode)
- Energy Efficient LED Lighting
- Programmable Digital Refrigeration Controller
- Adjustable Fan Speed
- Lift-Up Evaporator
- Easy Slide-Out Condensing Unit
- Slide-in Base
- Rear Air Ventilation Kit
- ETL Listed in Accordance with UL 471 and NSF 7 Standards (Cold Display)
- ETL Listed in Accordance with UL 197 and NSF 4 Standards (Hot Display)
- Environmentally Safe Refrigerant
- 5 Year Compressor Warranty
- Floor Drain Required

OPTIONAL FEATURES

- Remote Refrigeration
- Integrations Modular Counter (Consult Factory)
- Adjustable Legs & Casters (Slide-In Style Units)
 - 6" Legs 8" Legs 6" Casters



Conforms to UL Standard 471, and NSF Standard 7; Certified To CSA Standard C22.2 No.120

Conforms to UL Standard 197, and NSF Standard 4; Certified To CSA Standard C22.2 No.109

NOTE:

THE VSHC IS DESIGNED FOR NSF TYPE I ROOM CONDITIONS OF 75°F/55%RH. ANY DEVIATION IN TEMPERATURE OR HUMIDITY MAY INCREASE CHANCE OF CONDENSATION

MODEL	L	D*	H	COMP HP	VOLT	AMP	PLUG	WT	REFRIG.
VSHC2-20-R-SQ-SC-INS	35 7/8	40 1/8	42 5/8	3/8	115/208-230	7.15	L14-20P	484	R448A
VSHC3-20-R-SQ-SC-INS	51 3/4	40 1/8	42 5/8	1/2	115/208-230	7.45	L14-20P	550	R448A

* Depth includes rear cutting board. Cutting board can be removed, to fit through entrance, and be reinstalled once in place.

CALL TOLL FREE: 800-525-3692 (609-714-2330)

FAX: 609-714-2331 www.rpiindustries.com

220 ROUTE 70, MEDFORD, NJ 08055

MODEL # VSHC-INS

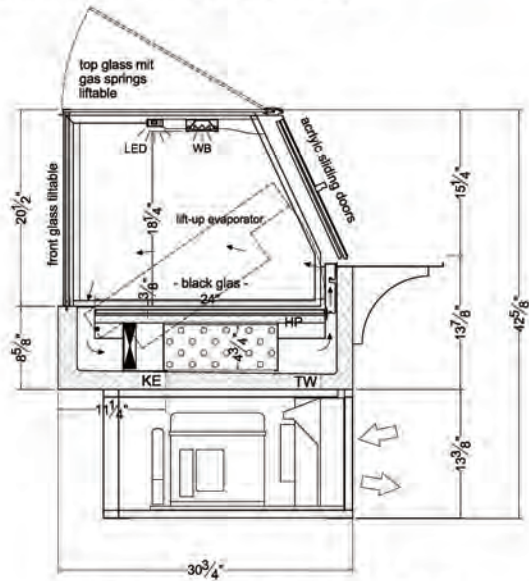

VSHC2-20-R-SQ-SC-INS



VSHC2



VSHC3

Electrical & Plumbing locations

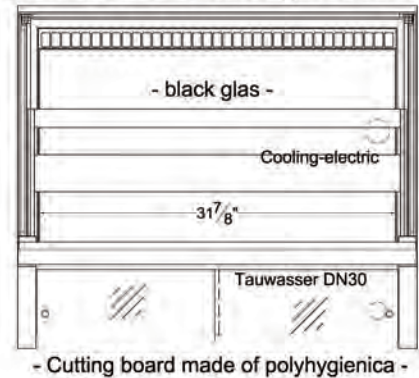

- Condensing unit easily slides out.
DO NOT BLOCK this area.
- Condensing unit requires adequate ventilation.

1. A 1" diameter drain is provided. The drain **MUST** be run to a floor drain **AT TIME OF INSTALLATION**.
2. RPI Merchandiser is designed for use in stores where ambient temperatures and humidity do not exceed 75 Degrees Fahrenheit and 55% R.H. Locate away from direct sunlight, rapid air currents and extreme temperature changes. Exposure to air currents from ceiling fans, air conditioning diffusers, ovens, etc. will disrupt the case air curtain and refrigerated zone. Refrigerated Displays are designed to maintain pre-chilled products. Adding or loading warm products above 41 Degrees Fahrenheit can affect the temperature in the entire cabinet.
Any adverse field conditions stated above will void warranty.

RPI in line with its policy to continually improve its products reserves the right to change materials and specifications without notice.

CALL TOLL FREE: 800-525-3692 (609-714-2330)

FAX: 609-714-2331 www.rpiindustries.com

220 ROUTE 70, MEDFORD, NJ 08055