

MODEL # SCRFC UD

SPECIFICATIONS

The Bravo Air Screen with Upper Display SCRFC UD Series has two sections. An upper ambient display with a satin finish metal frame and glass front, sides and top, hinged glass rear doors, (2) adjustable glass shelves and a fluorescent canopy light. The lower section is a refrigerated self-service display with front and rear air grills, brushed aluminum interior ends and a choice of standard grade plastic laminate exterior. Optional stainless steel exterior available upon request.

Available lengths: ☐ 36"
 Available depths: ☐ 32 5/8"
 Available heights: ☐ 65 3/8"



STANDARD FEATURES

- DOE 2017 Compliant
- Self-Contained Refrigeration
- Metal Frame Base Construction with Lift-Out Black Louvered Air Grill for Easy Access to Compressor
- Standard Grade Laminated Exterior
- T-Mold Edge Protection
- Brushed Aluminum Interior Ends
- Ambient Glass Display (Upper Section)
- (2) Adjustable Glass Shelves (Upper Section)
- Hinged Glass Rear Doors (Upper Section)
- Stainless Steel Perforated Interior Back Panel (Lower Section)
- LED Top Canopy Light (Upper and Lower Section)
- Energy Efficient LED Lighting
- Removable Stainless Steel Deck Pan with Hemmed Edge to Contain Spills (Lower Section)
- Electronic Digital Control and Defrost Termination
- Red Indicator Light Alerts Operator if Condenser Requires Cleaning
- Digital Temperature Display
- Unique Internal Baffle Design for Compressor Noise Reduction
- Front Air Intake with Rear Air Discharge for Zero Clearance
- 8' Cord and Plug
- Conforms to NSF STD 7 Refrigeration
- Environmentally Safe Refrigerant
- 1 Year Parts and Labor Warranty
- Floor Drain Required
- 5 Year Compressor Warranty

OPTIONAL FEATURES

- ☐ Green Screen
- ☐ Remote Refrigeration
- ☐ Stainless Steel Exterior Finish with Standard T-Molding
 - ☐ #4 ☐ #6 ☐ #8
- ☐ Special Laminates
- ☐ Wood Veneers (Stained & Sealed)
- ☐ Miscellaneous Trim
- ☐ Black Styrene Step Sham
- ☐ Stainless Steel Step Sham
- ☐ 10 Inch Middle Shelf
- ☐ Casters (Increases Height by 4")
- ☐ Adjustable Legs (Consult Factory for Sizes)
- ☐ Powder Coated Interior Back Panel and Hardware
 - ☐ Black ☐ White ☐ Custom Color
- ☐ Mirrored Polished Stainless Steel Interior Ends (#8 Finish)
- ☐ Mirrored Polished Stainless Steel Perforated Interior Back Panel (#8 Finish)
- ☐ Finished Back with Black Air Grill
- ☐ Stainless Steel Louvered Air Grill
- ☐ Removable Locking Security Panels
- ☐ Energy Efficient #23 Pull-Down Night Curtain
- ☐ Thermometer

CALL TOLL FREE: 800-525-3692 (609-714-2330)

FAX: 609-714-2331 www.rpiindustries.com

220 ROUTE 70, MEDFORD, NJ 08055



INDUSTRIES, INC. v8_31_17

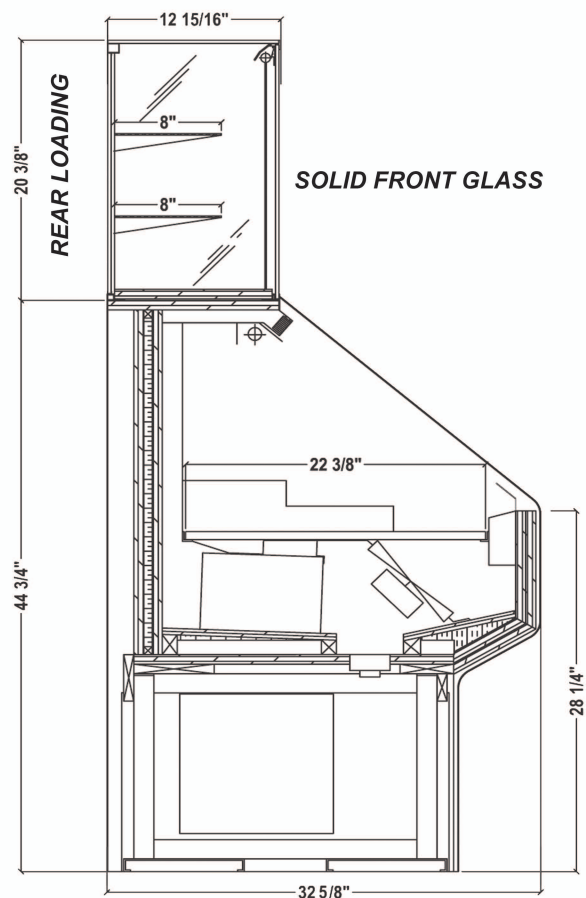

MODEL # SCRFC UD**SELF - CONTAINED**

MODEL	L	D	H	HP	VOLT	AMP	PLUG	WT	REFRIG.
SCRFC3648R UD 36	32 5/8	65 3/8	1/2	115	12.9	5-20P	450	134A	

AMBIENT

MODEL	L	D	H	VOLT	AMP	PLUG	WT
SCRFC3648D UD 36	32 5/8	65 3/8	115	0.16	5-15P	400	

REMOTE - REFRIGERATED

MODEL	BTU @ 20° F	VOLT	AMP	PLUG	WT	REFRIG.
SCRFC3648R-RR UD	4140	115	1.1	5-15P	400	Verify

GLYCOL

MODEL	BTU @ 20° F	VOLT	AMP	PLUG	WT	GPM	REFRIG.
SCRFC3648R-RR-GL UD	4140	115	1.1	5-15P	400	1.0	GLYCOL

UNIT SHOWN WITH OPTIONAL STEP SHAM

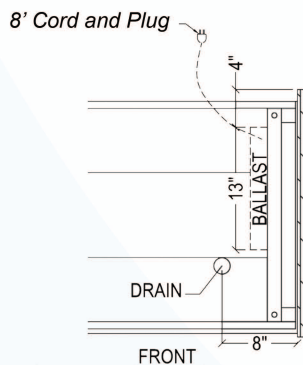
**Electrical & Plumbing locations**

Conforms to UL Standard 471,
and NSF Standard 7; Certified
To CSA Standard C22.2 No. 120



RPI refrigerated merchandisers configured for sale for use in the United States meet or surpass the requirements of the DOE 2017 energy efficiency standards

1. All Self-Contained, Remote and Glycol Units must be run to a floor drain at time of installation.
2. Refrigeration System is designed so air will flow front to rear. Unobstructed air flow must be maintained to ensure unit performance and maintain warranty.
3. The SCRFC UD merchandiser is designed for use in stores where ambient temperatures and humidity do not exceed 75 Degrees Fahrenheit and 55% R.H. Locate away from direct sunlight, rapid air currents and extreme temperature changes. Exposure to air currents from ceiling fans, air conditioning diffusers, ovens, etc. will disrupt the case air curtain and refrigerated zone. Refrigerated Displays are designed to maintain pre-chilled products. Adding or loading warm products above 41 Degrees Fahrenheit can affect the temperature in the entire cabinet. Any adverse field conditions stated above will void warranty.

RPI in line with its policy to continually improve its products reserves the right to change materials and specifications without notice.

CALL TOLL FREE: 800-525-3692 (609-714-2330)

FAX: 609-714-2331 www.rpiindustries.com

220 ROUTE 70, MEDFORD, NJ 08055



RPI INDUSTRIES, INC. v8_31_17