

MODEL # SCRFC4848 MS

SPECIFICATIONS

The Manhattan SCRFC MS Series is a three section display case consisting of a refrigerated self-service lower section, a refrigerated operator serve mid section and an operator serve non-refrigerated upper section. The lower section has a hemmed edge removable deck pan to contain spills. A glass shelf separates the mid and bottom sections for better visibility of product.

- Available lengths: 48"
 Available depths: 35 3/4"
 Available heights: 65 1/4"



STANDARD FEATURES

- Self-Contained Refrigeration
- Standard Grade Laminate Exterior
- Brushed Stainless Steel Interior Ends
- Adjustable Stainless Steel Shelf with T5 Light (Lower Section)
- Removable Plexi Glass Sliding Doors (Upper Section)
- See-Through Mirrored Rear Sliding Doors (Lower Section)
- Top Canopy Light
- Energy Efficient LED Lighting
- Intermediate Tempered Glass Shelf with Light (Mid Section)
- Removable Stainless Steel Deck Pan with Hemmed Edge to Contain Spills
- Electronic Digital Control and Defrost Termination
- Red Indicator Light Alerts Operator if Condenser Requires Cleaning
- Digital Temperature Display
- 8' Cord and Plug
- ETL Listed in Accordance with UL 471 and NSF 7 Standards
- Environmentally Safe Refrigerant
- 1 Year Parts and Labor Warranty
- 5 Year Compressor Warranty

OPTIONAL FEATURES

- Remote Refrigeration
- Stainless Steel Exterior Finish
 - #4 #6 #8
- Special Laminates
- Wood Veneers (Stained & Sealed)
- Casters (Increases Height by 4")
- Adjustable Legs (Consult Factory for Sizes)
- Mirrored Polished Stainless Steel Interior Ends (#8 Finish)
- Removable Locking Security Panels (Lower Section)
- Rear Door Locks
- Thermometer

UNIT SHOWN WITH OPTIONAL STAINLESS STEEL EXTERIOR FINISH



CALL TOLL FREE: 800-525-3692 (609-714-2330)
 FAX: 609-714-2331 www.rpiindustries.com
 220 ROUTE 70, MEDFORD, NJ 08055

RPI INDUSTRIES, INC. v5_30_23

MODEL # SCRFC4848 MS

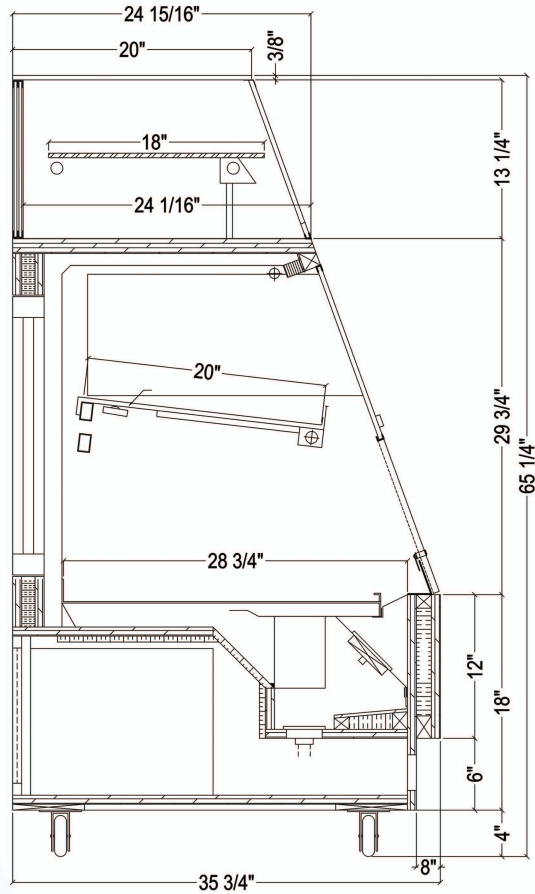

UNIT SHOWN WITH OPTIONAL CASTERS

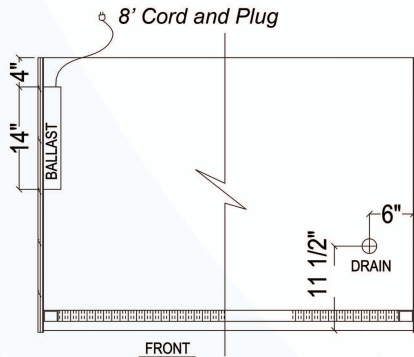

Electrical & Plumbing locations

1. All Self-Contained, Remote and Glycol Units must be run to a floor drain at time of installation.
2. Refrigeration System is designed so air will flow front to rear. Unobstructed air flow must be maintained to ensure unit performance and maintain warranty.
3. The SCRFC4848 MS merchandiser is designed for use in stores where ambient temperatures and humidity do not exceed 75 Degrees Fahrenheit and 55% R.H. Locate away from direct sunlight, rapid air currents and extreme temperature changes. Exposure to air currents from ceiling fans, air conditioning diffusers, ovens, etc. will disrupt the case air curtain and refrigerated zone. Refrigerated Displays are designed to maintain pre-chilled products. Adding or loading warm products above 41 Degrees Fahrenheit can affect the temperature in the entire cabinet. Any adverse field conditions stated above will void warranty.

RPI in line with its policy to continually improve its products reserves the right to change materials and specifications without notice.

CALL TOLL FREE: 800-525-3692 (609-714-2330)
 FAX: 609-714-2331 www.rpiindustries.com
 220 ROUTE 70, MEDFORD, NJ 08055

RPI INDUSTRIES, INC. v5_30_23

SELF - CONTAINED

MODEL	L	D	H	HP	VOLT	AMP	PLUG	WT	REFRIG.
SCRFC4848 MS	48	35 3/4	65 1/4	1/2	115	11.75	5-15P	800	134A

* 448a refrigeration available at no additional cost - please specify

REMOTE - REFRIGERATED

MODEL	BTU @ 20° F	VOLT	AMP	PLUG	WT	REFRIG.
SCRFC4848-RR MS	4140	115	2.4	5-15P	750	Verify

GLYCOL

MODEL	BTU @ 20° F	VOLT	AMP	PLUG	WT	GPM	REFRIG.
SCRFC4848-RR-GL MS	4140	115	2.4	5-15P	750	1.0	GLYCOL



Conforms to UL Standard 471, and NSF Standard 7; Certified To CSA Standard C22.2 No. 120



RPI refrigerated merchandisers configured for sale for use in the United States meet or surpass the requirements of the DOE 2017 energy efficiency standards