

MODEL # SCMB H42

SPECIFICATIONS

The Monarch Bakery Specialty Series display SCMB H42 case is a Bakery display case is available with a choice of standard grade plastic laminate exterior. The case is designed to work as a stand-alone case or along-side of a Bravo H42 case to create a unique side by side design of service and self-service display in a continuous counter or as individual cases. Units are available in both refrigerated and ambient.

Available lengths: ☐ 36" ☐ 48" ☐ 60" ☐ 72"

Available depths: ☐ 32"

Available heights: ☐ 42"



STANDARD FEATURES

- Self Contained Refrigeration
- Fixed Flat Heated Front Glass
- Standard Grade Laminate Exterior
- Black Base
- 1/2" Thick Insulated Glass Side Panels with Heater Wire**
- #8 Mirror Glass Trim
- Interior Vision End Panels
- White Laminated Deck
- LED Top Canopy Light
- (1) Tempered Glass Shelf with LED Lights
- See-Through Mirrored Rear Sliding Doors
- Thermometer
- 8' Cord and Plug
- ETL Listed in Accordance with UL 471 and NSF 7 Standards
- Environmentally Safe Refrigerant
- 1 Year Parts and Labor Warranty
- 5 Year Compressor Warranty

OPTIONAL FEATURES

- ☐ Remote Refrigeration (Floor Drain Required)
- ☐ Stainless Steel Exterior Finish
 - ☐ #4 ☐ #6 ☐ #8
- ☐ Special Laminates
- ☐ Wood Veneers (Unfinished)
- ☐ Wood Veneers (Stained & Sealed)
- ☐ Miscellaneous Trim
- ☐ Brass Trim and Hardware
- ☐ Wire Shelves
 - ☐ Brass ☐ White ☐ Black ☐ Chrome
- ☐ Casters (Increases Height by 4")
- ☐ Adjustable Legs (Consult Factory for Sizes)
- ☐ Mirrored Polished Stainless Steel Interior Ends (#8 Finish)
- ☐ Stainless Steel Deck
- ☐ Rear Door Locks
- ☐ 8" Wrap Board
- ☐ Corian® Surface Top
- ☐ Granite Surface Top

If the case is ambient and stand alone it will be provided with UV bonded glass. In the event an ambient case is joined with an airtight or heated cases, the UV bonded glass will be changed to insulated glass



CALL TOLL FREE: 800-525-3692 (609-714-2330)

FAX: 609-714-2331 www.rpiindustries.com

220 ROUTE 70, MEDFORD, NJ 08055



INDUSTRIES, INC. v10_10_19

MODEL # SCMB H42

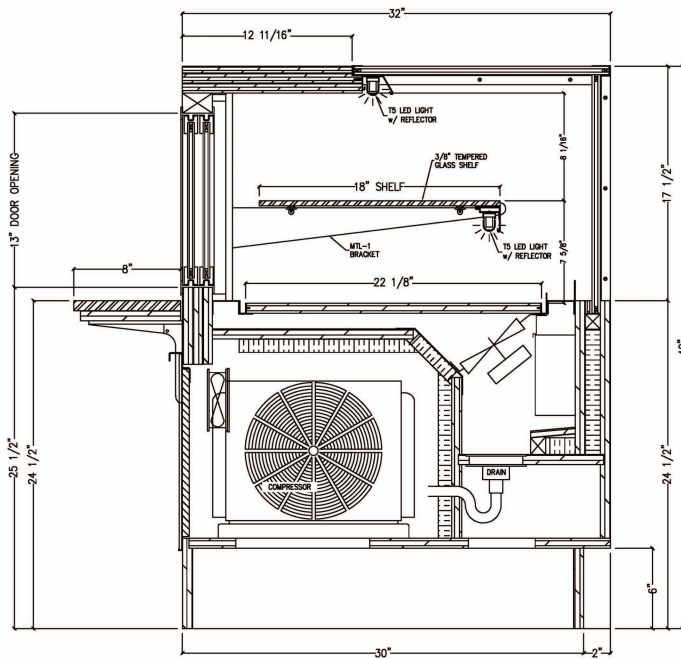

SELF - CONTAINED

| MODEL | L | D | H | HP | VOLT | AMP | PLUG | WT | REFRIG. |
|-------------|----|----|----|-----|------|------|-------|-----|---------|
| SCMB36R H42 | 36 | 32 | 42 | 1/4 | 115 | 7.7 | 5-15P | 525 | 134A |
| SCMB48R H42 | 48 | 32 | 42 | 1/3 | 115 | 10.1 | 5-15P | 675 | 134A |
| SCMB60R H42 | 60 | 32 | 42 | 1/3 | 115 | 10.2 | 5-15P | 700 | 134A |
| SCMB72R H42 | 72 | 32 | 42 | 1/2 | 115 | 14.7 | 5-20P | 800 | 134A |

AMBIENT

| MODEL | L | D | H | VOLT | AMP | PLUG | WT |
|-------------|----|----|----|------|-----|-------|-----|
| SCMB36D H42 | 36 | 32 | 42 | 115 | .30 | 5-15P | 325 |
| SCMB48D H42 | 48 | 32 | 42 | 115 | .60 | 5-15P | 450 |
| SCMB60D H42 | 60 | 32 | 42 | 115 | .70 | 5-15P | 550 |
| SCMB72D H42 | 72 | 32 | 42 | 115 | .80 | 5-15P | 700 |

REMOTE - REFRIGERATED

| MODEL | BTU @ 20° F | VOLT | AMP | PLUG | WT | REFRIG. |
|----------------|-------------|------|------|-------|-----|---------|
| SCMB36R-RR H42 | 1890 | 115 | 1.48 | 5-15P | 490 | Verify |
| SCMB48R-RR H42 | 2360 | 115 | 1.56 | 5-15P | 640 | Verify |
| SCMB60R-RR H42 | 2360 | 115 | 1.62 | 5-15P | 660 | Verify |
| SCMB72R-RR H42 | 4140 | 115 | 2.36 | 5-15P | 760 | Verify |

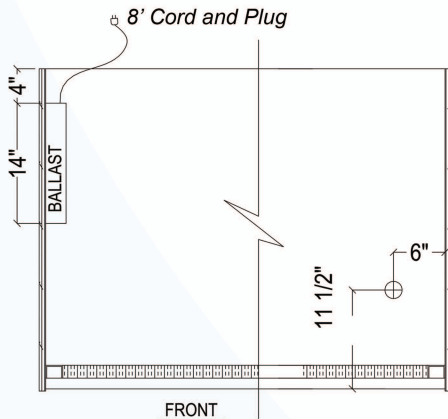

Electrical & Plumbing locations



Conforms to UL Standard 471,
and NSF Standard 7; Certified
To CSA Standard C22.2 No.120



RPI refrigerated merchandisers configured for sale for use in the United States meet or surpass the requirements of the DOE 2017 energy efficiency standards

1. All Remote and Glycol units must be run to a floor drain at time of installation.
 2. The SCMB-H42 merchandiser is designed for use in stores where temperature and humidity do not exceed 75 degrees F and 55% R.H. Locate away from direct sunlight, rapid air currents and extreme temperature changes. Any adverse field conditions stated above will void warranty.
- RPI in line with it's current policy to continually improve it's product reserves the right to change materials and specifications without notice.

CALL TOLL FREE: 800-525-3692 (609-714-2330)

FAX: 609-714-2331 www.rpiindustries.com

220 ROUTE 70, MEDFORD, NJ 08055

RPI INDUSTRIES, INC. v10_10_19